



FLOATING DUST COLLECTION GUARD

OWNER'S MANUAL

MODEL TSG-FDC



Copyright SawStop, LLC
All Rights Reserved

2nd printing, November 2017

Updates of this manual may be
available at www.sawstop.com

The saw shown on the front cover is the Industrial Cabinet Saw, Model ICS.
Your saw may look different.

SawStop, the SawStop blade logo, and the configuration of this product are either registered trademarks or trademarks of SawStop, LLC. Software copyright by SawStop, LLC. All rights reserved.

TO OUR CUSTOMERS

Thank you for purchasing the SawStop Floating Dust Collection Guard. We are confident you will be pleased with its quality and performance.

This manual tells you more about your dust collection guard and how to operate and maintain it. Please read the manual carefully. The manual also includes our warranty and important safety information.

If you ever have any questions or comments, feel free to contact us at the address below.

SawStop, LLC
11555 SW Myslony Street | Tualatin, Oregon 97062 USA

Phone: (503) 570-3200

Fax: (503) 570-3303

Email: info@sawstop.com

www.sawstop.com

HOW TO GET HELP

Missing Parts? Have Questions?

Our technical support team is standing by
M-F, 6:30am-5pm PST
to help with whatever you need.



Give us a call at
503.582.9934



Email us at
SERVICE@SAWSTOP.COM



TABLE OF CONTENTS

Product Specifications.....	1
Parts Inventory.....	2
Parts and Hardware Lists.....	2
Tools Needed.....	3
Assembly Instructions.....	4
Attaching the Extension Leg to the Dust Collection Guard Mounting Bracket.....	4
Attaching the Dust Collection Guard Mounting Bracket to the Extension Table.....	5
Assembling the Leg Support Brackets.....	9
Attaching the Leg Support Brackets to the Dust Collection Guard Mounting Bracket....	10
Attaching the Leg Support Brackets to the Extension Table.....	11
Attaching the Dust Tubes to the Dust Collection Guard Mounting Bracket.....	14
Attaching the Floating Blade Guard to the Dust Tube.....	16
Attaching the Dust Hose to the Dust Tube and the Floating Blade Guard.....	18
Connecting to a Dust Collection System	19
Adjusting Your Floating Dust Collection Guard.....	20
Adjusting the Parallelism of the Dust Tube Assembly.....	20
Adjusting the Length of the Dust Tube Assembly.....	20
Adjusting the Floating Blade Guard Height.....	21
Adjusting the Floating Blade Guard Spring.....	22
Maintenance.....	23
Reference.....	24
Warranty.....	24
Safety.....	25
Warnings.....	26
Warning Labels.....	26
Exploded View.....	27
Parts List.....	28

PRODUCT SPECIFICATIONS

The SawStop Floating Dust Collection Guard is designed as a blade cover and dust collection hood. It is intended for use on SawStop cast iron table saws. The transparent floating guard back plate can be cut or removed to provide clearance for safety devices such as riving knives, splitters, and anti-kickback pawls. The Floating Dust Collection Guard is compatible with dado stacked blades.

Product Specifications	
Net Weight	58 lbs
Floating Blade Guard Dimension	3.5" x 18.5"
Distance Between Blade and End of Extension Table	35.75" to 68"
Inner Dust Tube Diameter	3"
Outer Dust Tube Diameter	4"
Outer Dust Tube Height Above Table	13.6"
Outer Dust Tube Height Above Floor	33.5" to 50"



Parts and Hardware Lists

The Floating Dust Collection Guard is shipped partially assembled. Please unpack the parts carefully and confirm you have received each item on the list below.

Parts

- A.** Extension Leg (1)
- B.** Dust Collection Guard Mounting Bracket (1)
- C.** Leg Support Bracket (2)
- D.** Outer Dust Tube (1)
- E.** Inner Dust Tube (1)
- F.** Floating Blade Guard (1)
- G.** Dust Collection Hose (1)
- H.** Hardware Pack (1)



Hardware

- I.** 1/4"-20 Extension Leg Lock Knob (2)
- J.** M6 x 19 x 1 Washer (8)
- K.** M6 x 1.0 x 40mm Hex Head Bolt (4)
- L.** M6 x 1.0 Nut (4)
- M.** 1/4"-20 x 3/4" Flat Head Socket Screw (2)
- N.** 1/4"-20 x 4" Eye Bolt (2)
- O.** Leg Support Mounting Bracket (2)
- P.** 1/4" Lock Washer (6)
- Q.** 1/4"-20 x 1/2" Hex Head Bolt (2)
- R.** M5 x 12 x 1 Washer (2)
- S.** M5 x 2.1 x 32 Button Head Phillips Screw (2)
- T.** M6 x 1.0 x 40 Button Head Socket Screw (1)
- U.** M6 x 1.0 Lock Nut (1)
- V.** 1/4"-20 Nut (8)
- W.** Hose Clamp (2)

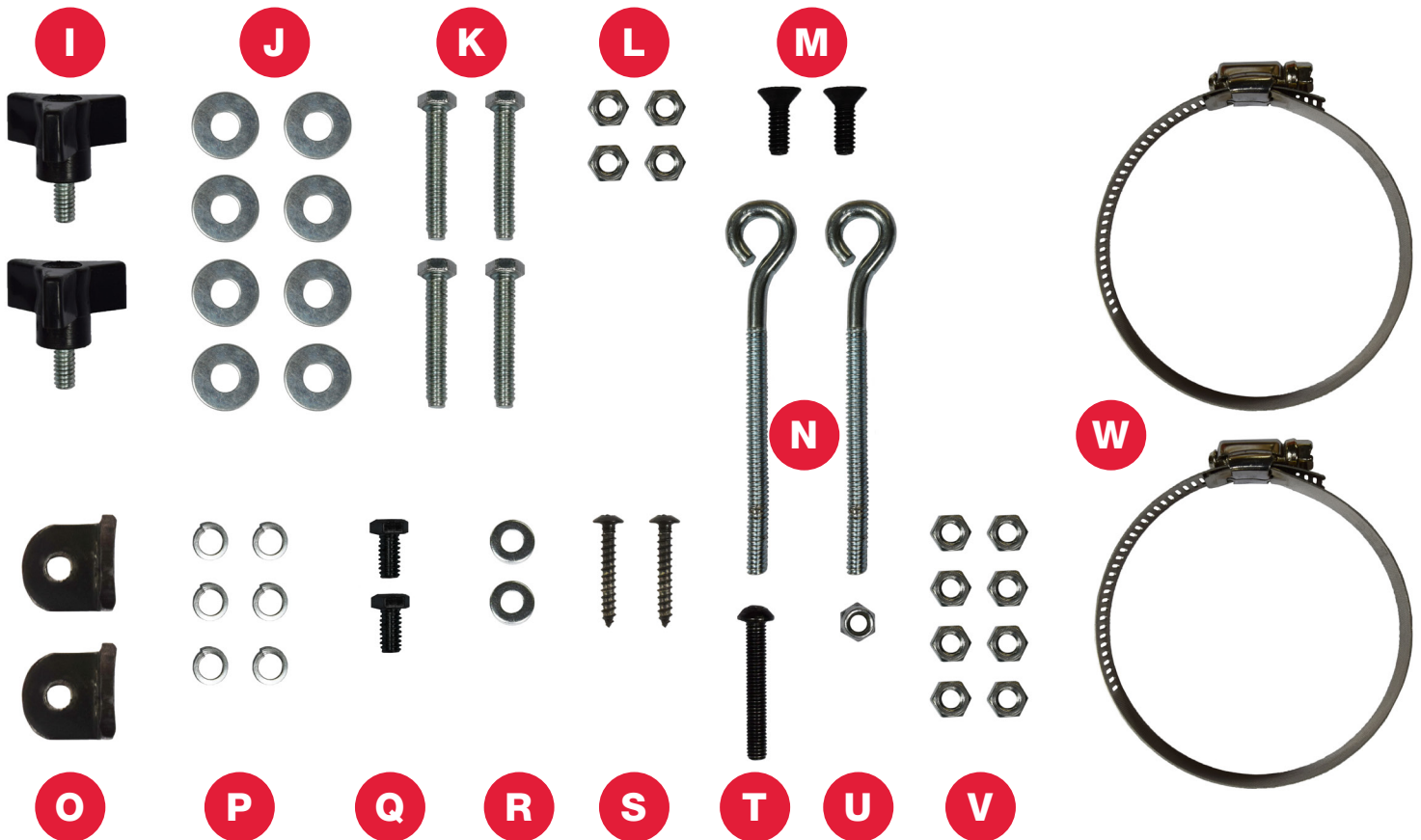

Tools Needed

- Drill with 1/4" and 7/64" Drill Bits
- 7/16", 1/2", and 9/16" Wrenches
- 10mm Wrench
- 4mm Allen Wrench
- Measuring Tape
- Flathead and Phillips Screwdrivers or Driver Bits
- Pen or Pencil

Attaching the Extension Leg to the Dust Collection Guard Mounting Bracket

- 1 Slide the hollow end (the end without the cap) of the extension leg (A) about 3 inches into the leg portion of the dust collection guard mounting bracket (B).

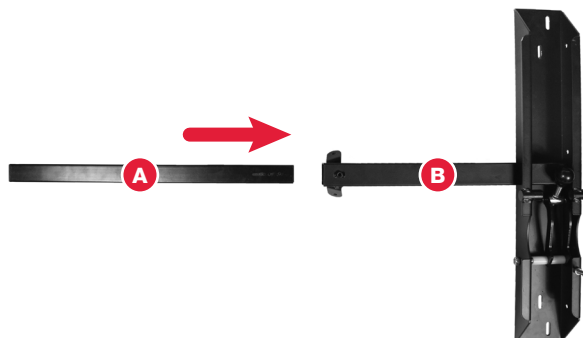

- 2 Adjust the overlap between the extension leg (A) and the dust collection guard mounting bracket (B) until the top of the dust collection guard mounting bracket approximately matches the height of your extension table.

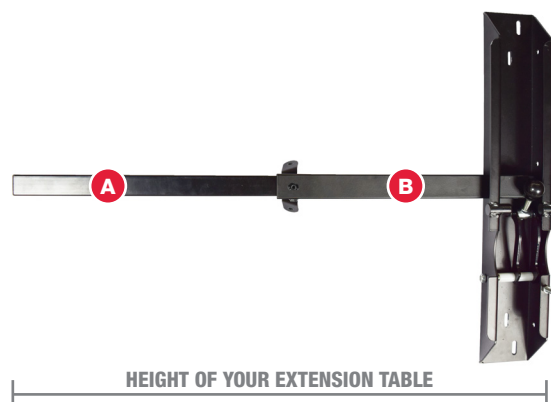

The exact height is not critical at this point, as it can be adjusted after the dust collection guard mounting bracket is attached to the extension table.

- 3 Thread the two 1/4"-20 extension leg lock knobs (I) into the two nuts on the dust collection guard mounting bracket (B). Tighten the extension leg lock knobs evenly to secure the extension leg.

The extension leg lock knobs should engage the extension leg and lock it against further movement. This will help prevent potential injury due to unexpected movement of the floating dust collection guard.

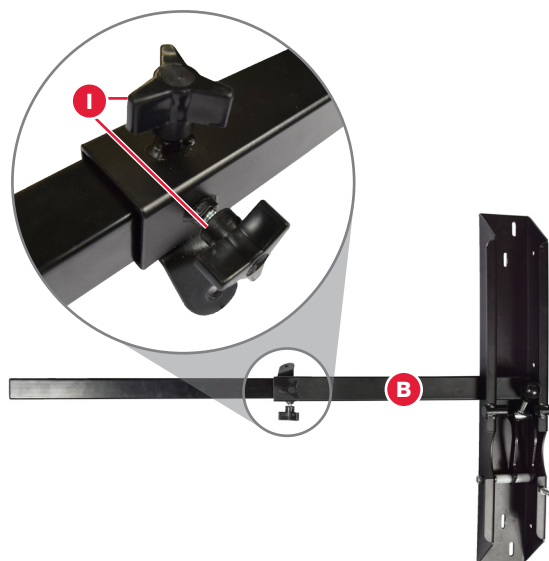

Attaching the Dust Collection Guard Mounting Bracket to the Extension Table

- 1 Place the flat edge of the dust collection guard mounting bracket (B) against the right edge of the extension table on your saw, with the top of the dust collection guard mounting bracket flush or just below flush with the top of the extension table.

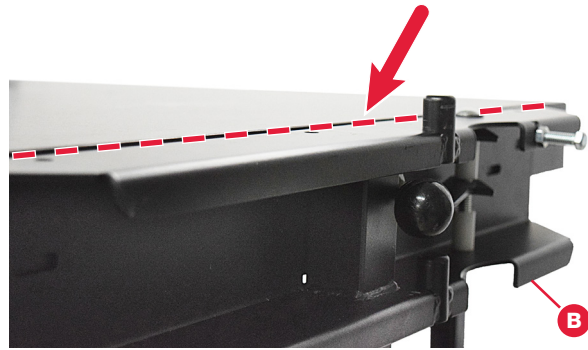

- 2 Reference the table and figure below for accurate placement of the bracket based on your saw model configuration. The mounting pins on the dust collection guard mounting bracket (B) should align with the center of the blade.

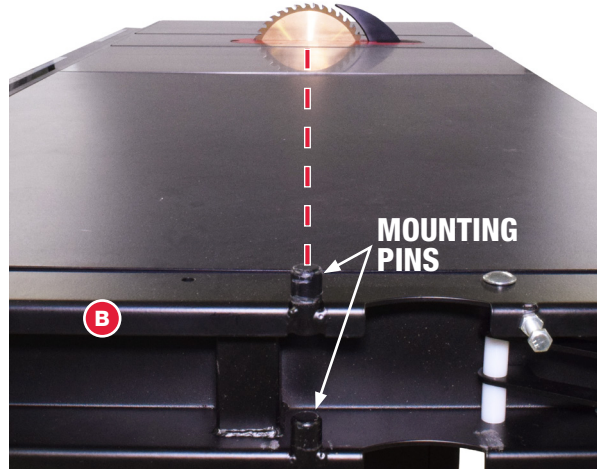

Bracket Mounting		
Saw	Extension Table	Distance Between Bracket and Rear of Extension Table
ICS	36"	4"
	52"	4"
PCS	TGP2 36"	1 5/8"
	TGP2 52"	1 5/8"
CNS	TGP2 36"	1"
	TGP2 52"	1"

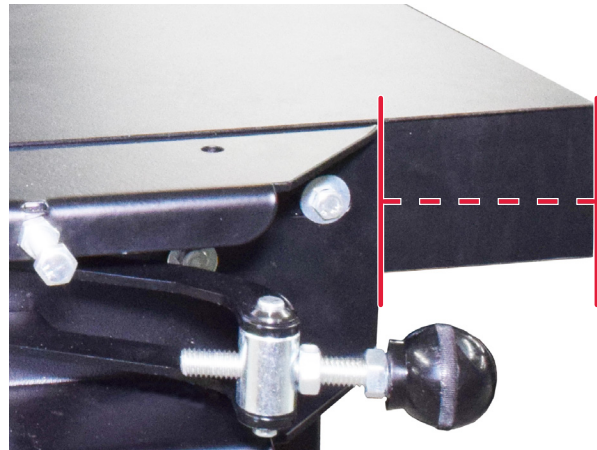

The distance between the mounting bracket and the rear edge of the extension table should match the value listed for your model saw in the table above.



The elongated mounting slots in the bracket will allow for some adjustment of the positioning if needed once it has been mounted to the extension table.

- 3 Place a mark on the extension table in the center of each of the four elongated mounting slots in the dust collection guard mounting bracket (B). Then place the dust collection guard mounting bracket and extension leg aside.



- 4 Use a 1/4" drill bit to drill four through-holes in the extension table at the locations marked in step 3.



- 5 Place the flat edge of the dust collection guard mounting bracket (B) in the same position as in step 2, with the mounting holes aligned with your drilled through-holes.

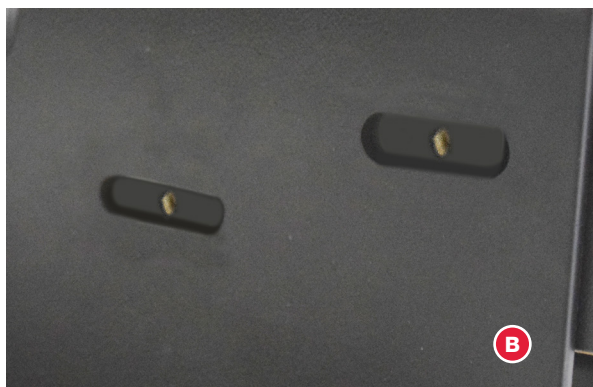

- 6** With the mounting holes aligned, insert a single M6 x 1.0 x 40 hex head bolt (K) through a M6 x 19 x 1 washer (J), then through one of the four exposed holes in the dust collection guard mounting bracket (B) and extension table, and then through a second M6 x 19 x 1 washer (J) and a M6 x 1.0 nut (L). Only finger-tighten the nut at this time.

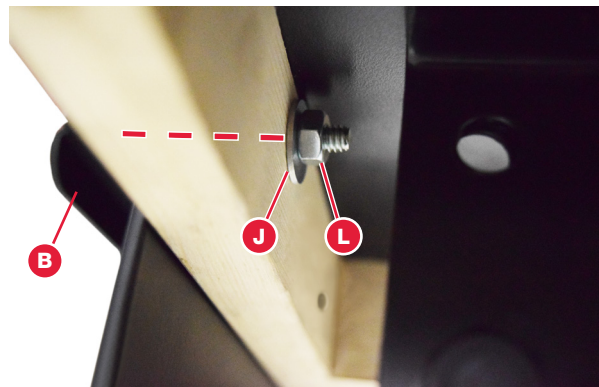
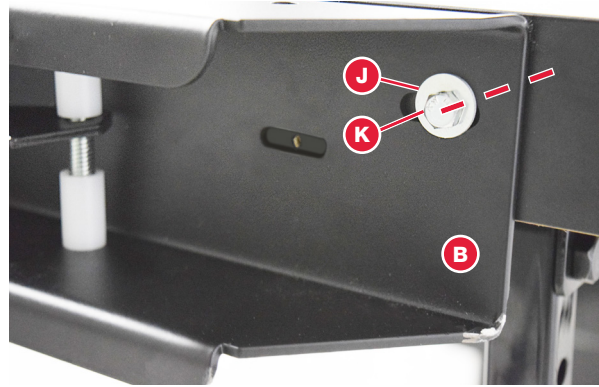

VIEW UNDER TABLE

- 7** Repeat this process for the remaining three holes in the dust collection guard mounting bracket and extension table.



- 8** Check to make sure that the dust collection guard mounting bracket is still positioned correctly against the extension. If the position needs to be adjusted, make use of the clearance provided by the elongated slots.

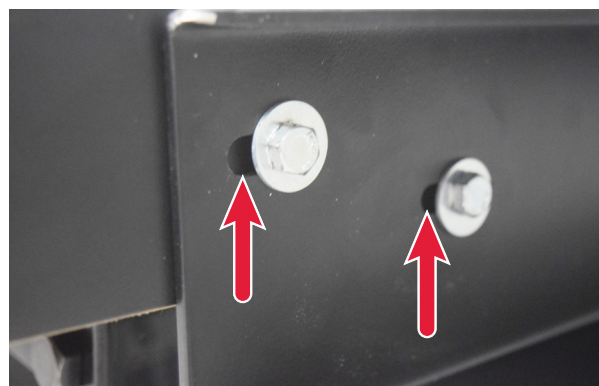

9

Using a 10mm wrench on the head of each bolt and an 10mm wrench on each nut, tighten the nuts on the bolts to secure the dust collection guard mounting bracket to the extension table.



10

Check to make sure that the extension leg is vertical. If necessary, adjust the extension leg lock knobs and/or the bolts attaching the dust collection guard mounting bracket to the extension table.



Assembling the Leg Support Brackets

- 1 Insert a 1/4"-20 x 3/4" flat head socket screw (M) through the eye of an eye bolt (N), and then through one of the holes in a leg support mounting bracket (O). Then place a 1/4" lock washer (P) onto the screw, followed by a 1/4"-20 nut (V). Only finger-tighten the nut at this time.

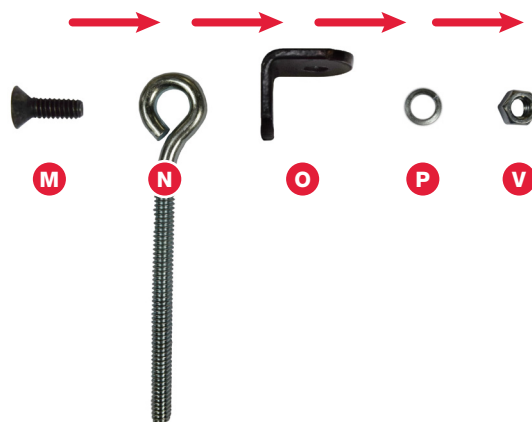

- 2 Repeat this process for the other eye bolt and leg support mounting bracket.



- 3 Thread a 1/4"-20 nut (V) about half way up the shaft of each eye bolt (N).

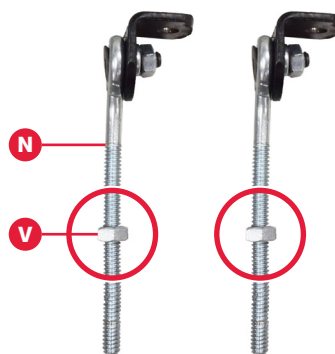

- 4 Insert the shaft of an eye bolt (N) through the hole in the bent end of a leg support bracket (C), followed by a 1/4" lock washer (P) and a 1/4"-20 nut (V). Only finger-tighten the nut at this time.

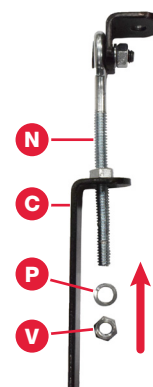

- 5 Repeat this process for the other leg support bracket.



Attaching the Leg Support Brackets to the Dust Collection Guard Mounting Bracket

- 1 Place the flat, non-bent end of a leg support bracket (C) against the exterior side of the front tab welded to the leg portion of the dust collection guard mounting bracket (B). Make sure the bent sections of the leg support bracket (C) and the leg support mounting bracket (O) face out toward the front of the saw.

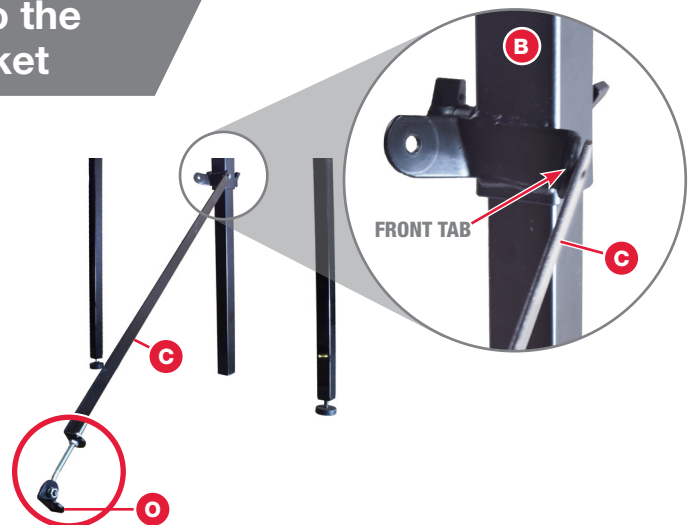

- 2 Insert a 1/4"-20 x 1/2" hex head bolt (Q) through the hole in the leg support bracket (C) and then through the tab of the dust collection guard mounting bracket, followed by a 1/4" lock washer (P) and a 1/4"-20 nut (V). Only finger-tighten the nut at this time.

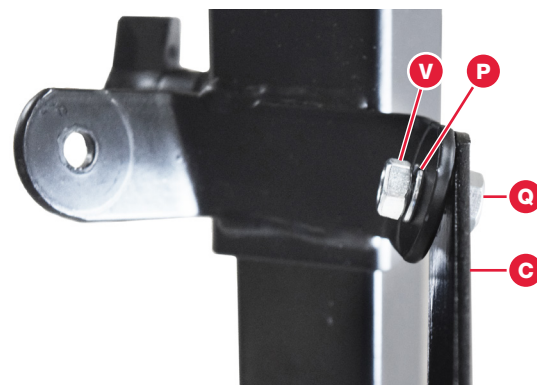

- 3 Repeat steps 1-2 to attach the other leg support bracket (C) to the exterior side of the rear tab, making sure the bent sections of the leg support bracket and the leg support mounting bracket face out toward the rear of the saw. Only finger-tighten the nut at this time.



Attaching the Leg Support Brackets to the Extension Table

- 1 Pivot the bent end (with the eye bolt assembly) of the front leg support bracket (C) up toward the underside of the wooden extension table support frame.

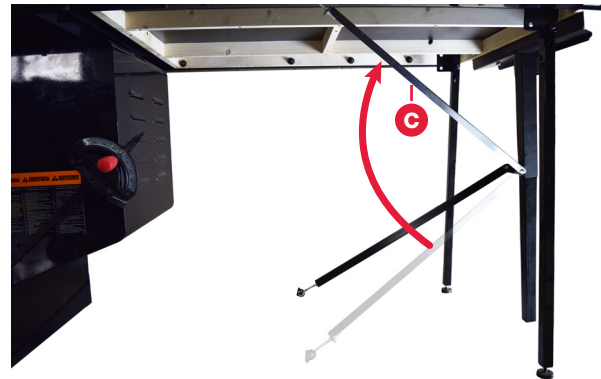

- 2 Rotate the leg support mounting bracket (O) and/or eye bolt (N) until the flat side of the leg support mounting bracket is flush with the outer portion of the extension table support frame.

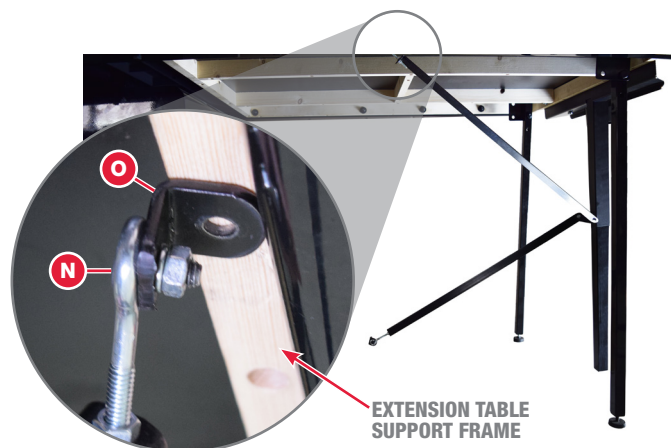

The point of contact between the leg support mounting bracket and the extension table can be adjusted by loosening the nuts on the eye bolt, moving it in or out relative to the leg support bracket, and then re-tightening the nuts.

i

If you have a 36" extension table, rotate the leg support mounting bracket (O) and/or eye bolt (N) until the flat side of the leg support mounting bracket is flush with the cross support frame of the extension table.

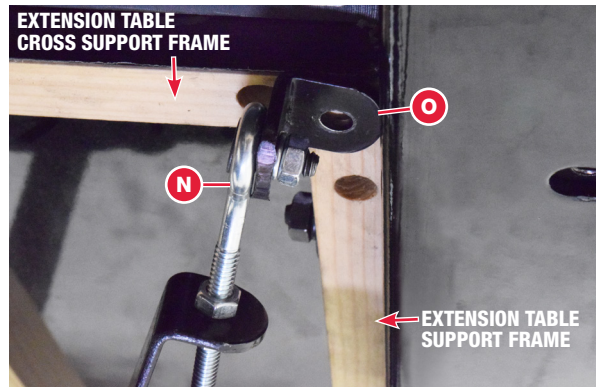

3

Make a mark on the underside of the extension table support frame in the center of the hole of the leg support mounting bracket (O).

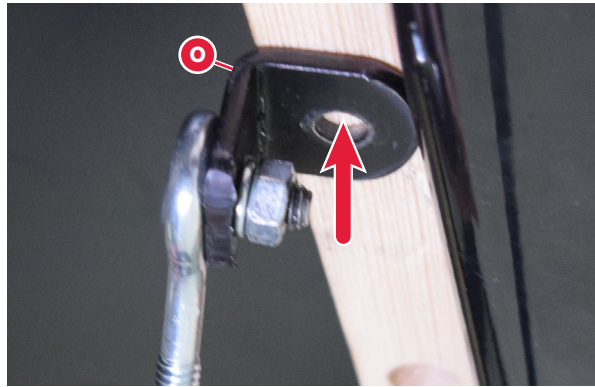

4

Pivot the leg support bracket back down to rest on the floor. Drill a pilot hole in the location you marked in step 3 with a 7/64" drill bit.

Be sure to drill into the cross support frame if you have a 36" extension table.

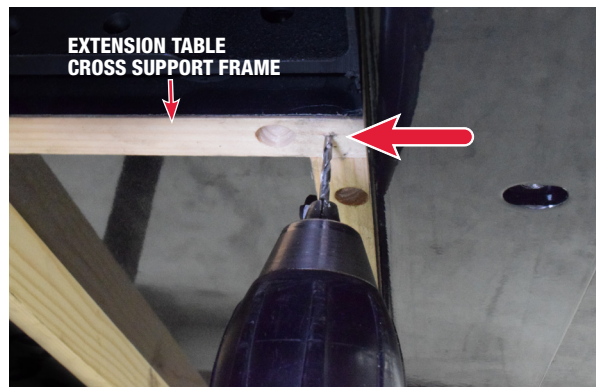

5

Pivot the leg support bracket and attached components up again and align the leg support mounting bracket hole with your drilled pilot hole.



- 6 Insert a M5 x 2.1 x 32 button head phillips screw (S) through a M5 x 12 x 1 washer (R) and then through the exposed hole in the leg support mounting bracket (O). Secure the bracket to the underside of the extension table support frame using a Phillips screwdriver or drill.

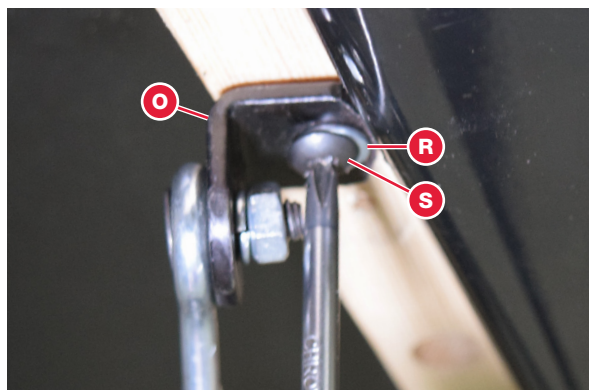

- 7 Repeat steps 1-6 for the rear leg support mounting bracket.

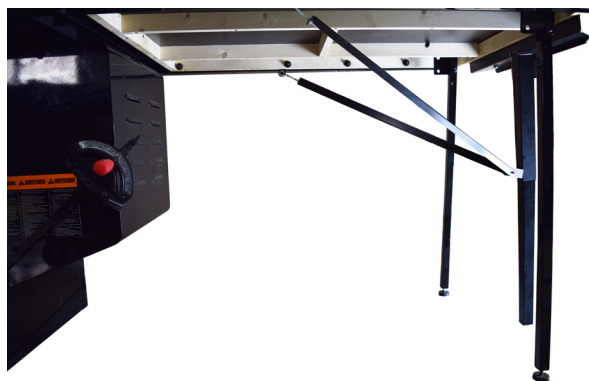

- 8 Check to make sure the extension leg is still vertical and make any necessary adjustments.

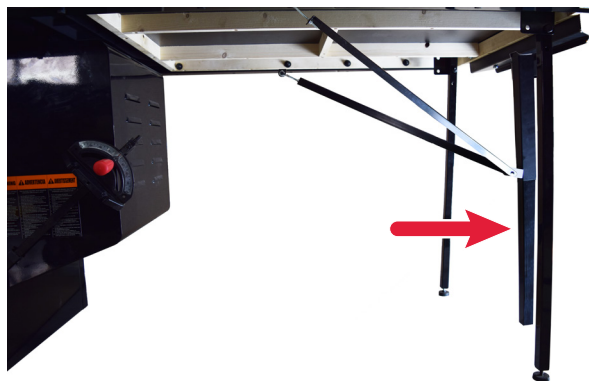

- 9 Use a 7/16" wrench to tighten the six 1/4"-20 nuts (V) on the eye bolts for the front and rear leg support mounting brackets.

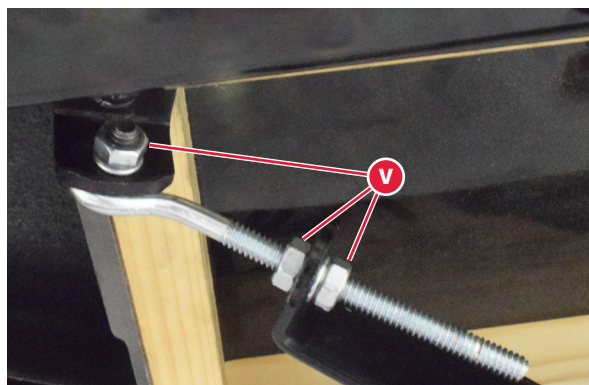

- 10** Use a 7/16" wrench to tighten the two 1/4"-20 nuts (V) on both leg support brackets.

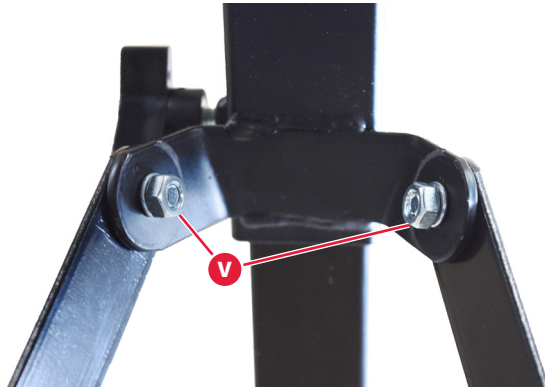

Attaching the Dust Tubes to the Dust Collection Guard Mounting Bracket



IT IS RECOMMENDED THAT TWO PEOPLE ATTACH THE DUST TUBES, AS THE DUST TUBE ASSEMBLY IS HEAVY AND COULD CAUSE SERIOUS PERSONAL INJURY OR DAMAGE IF DROPPED.

- 1** With the help of another person, lift the dust tube assembly (comprised of the inner and outer dust tubes (D,E)) and set them on the dust collection guard mounting bracket. Be sure that the pins on the dust collection guard mounting bracket (B) (indicated by the red arrows) pass through the holes in the bracket on the outer dust tube (indicated by the yellow circles).

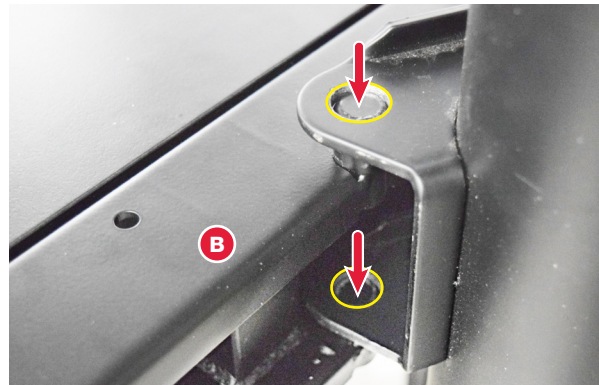

- 2** Pivot the dust tubes in towards the dust collection guard mounting bracket (B), so the dust tube assembly rests securely against the dust collection guard mounting bracket (B).

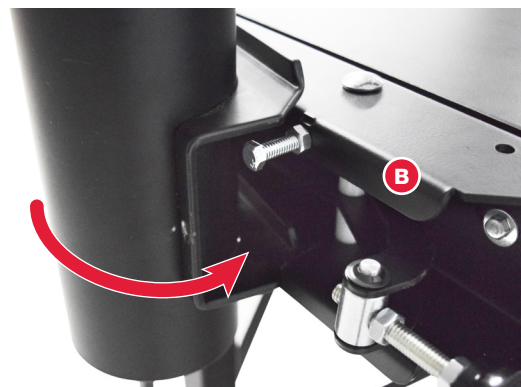

3

Grasp the end of the 3/8"-16 dust tube lock knob and pivot it towards the dust tube assembly until the end of the threaded portion of the lock knob lines up with the depression in the flat plate portion of the outer dust tube (D) and push it until it is over center past the depression.

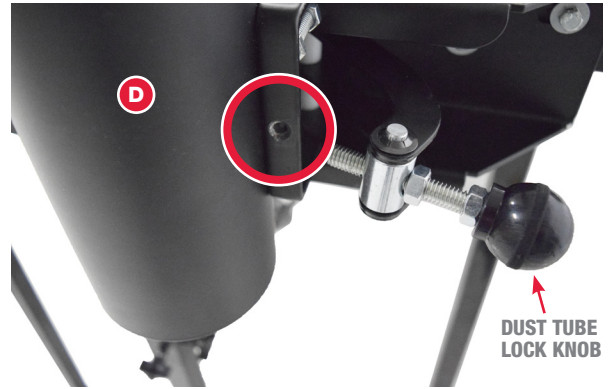

THE DUST TUBE LOCK KNOB WILL NOT SECURELY LOCK THE DUST TUBE ASSEMBLY AGAINST THE DUST COLLECTION GUARD MOUNTING BRACKET UNLESS IT IS JUST OVER CENTER PAST THE DEPRESSION.



The amount of clamping force exerted by the lock knob can be adjusted by loosening the nut adjacent the pivot point of the handle using a 9/16" wrench, and threading the handle in or out. Once the desired clamping pressure has been reached, the nut can be re-tightened.



Attaching the Floating Blade Guard to the Dust Tube

- 1 Slide the floating blade guard (F) onto the end of the inner dust tube (E) until about 1" of the inner dust tube extends past the floating blade guard.

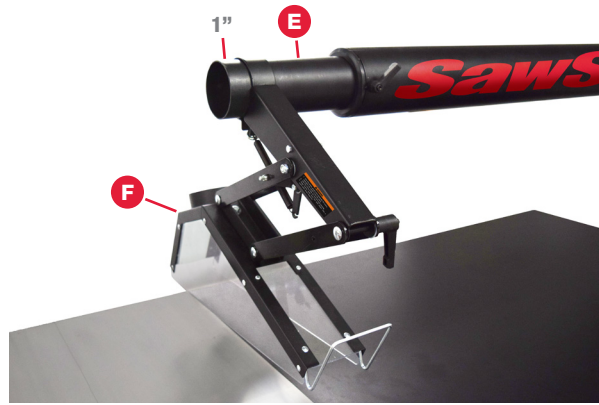

- 2 Slide a M6 x 1.0 x 40 button head socket screw (T) through the two holes in the clamping portion of the floating blade guard (F), with the threaded portion of the bolt facing towards the front of the floating blade guard.

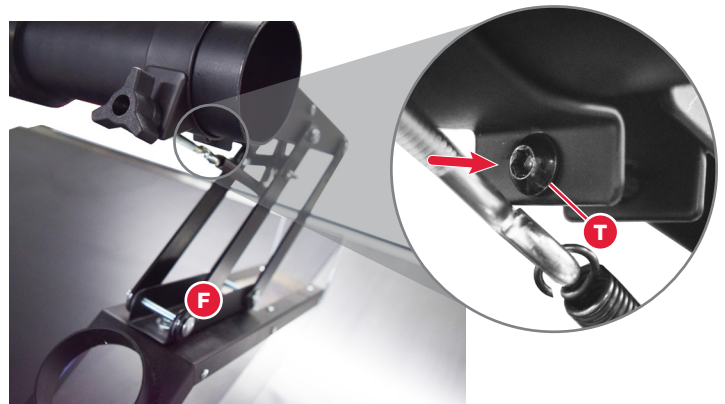

It may be useful to loosen the spring tension knob on the rear side of the clamping portion of the floating blade guard so the spring can be pushed out of the way.



- 3 Secure the button head socket screw in place with a M6 x 1.0 lock nut (U), using a 4mm allen wrench and a 10mm wrench.



- 4** Lock the floating blade guard in its upper, retracted position. To do this, loosen the floating guard lock handle and lift the clear hood portion up towards the inner dust tube. When the floating blade guard (F) is in its upper position, re-tighten the floating guard lock handle.



- 5** Loosen the inner dust tube lock knob and extend or retract the inner dust tube (E) to center the floating blade guard (F) over the blade. Then re-tighten the inner dust tube lock knob to secure the inner dust tube and floating blade guard.



IT IS RECOMMENDED THAT THE FLOATING BLADE GUARD ALWAYS BE LOCKED IN ITS UPPER POSITION BEFORE THE DUST TUBES ARE MOVED OR PIVOTED.



For bevel cuts, where the blade is tilted to the left, you may need to move the floating blade guard (F) to the left so it does not interfere with the teeth on the saw blade. First, turn off your saw and lock the floating blade guard in the upper, retracted position. Then, position the saw blade at the desired angle and elevation. Carefully lower the guard and telescope the inner dust tube (E) further to the left side of the saw as necessary, checking the clearance between the sides of the guard and the teeth on the blade.



ALWAYS CHECK THE POSITION OF THE FLOATING BLADE GUARD (F) PRIOR TO BEGINNING ANY CUTS, TO MAKE SURE IT WILL NOT INTERFERE WITH THE TEETH ON THE SAW BLADE.

Attaching the Dust Collection Hose to the Dust Tube and the Floating Blade Guard

- 1 Slide a hose clamp (W) just over each end of the dust collection hose (G).

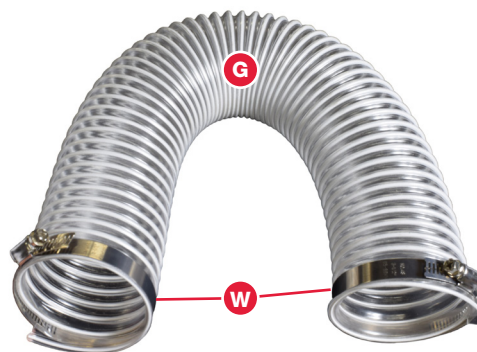

- 2 Slide one end of the dust hose (G) over the end of the inner dust tube (E), making sure that the hose clamp is about 1/4" to 1/2" inset from the end of the dust tube.

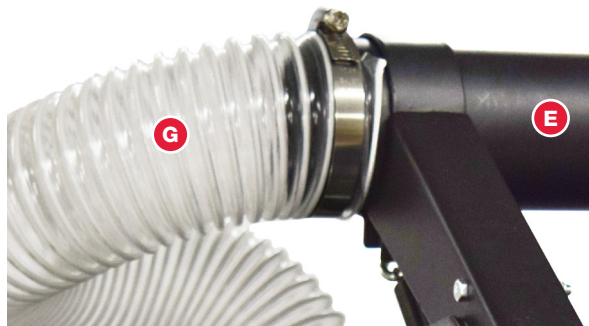

- 3 Slide the other end of the dust hose (G) onto the floating blade guard (F), making sure the hose clamp is about 1/4" to 1/2" over the edge of the floating blade guard 4" port.

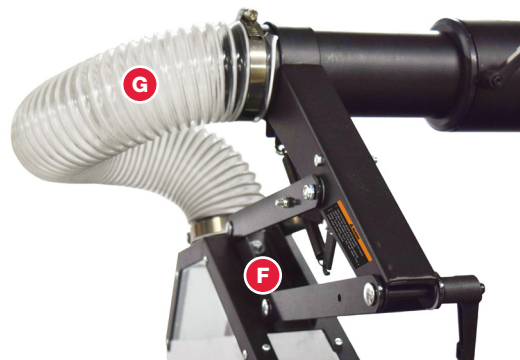

- 4 Using a screwdriver, tighten the hose clamps (W) to secure the dust hose to the inner dust tube (E) and the floating blade guard (F).

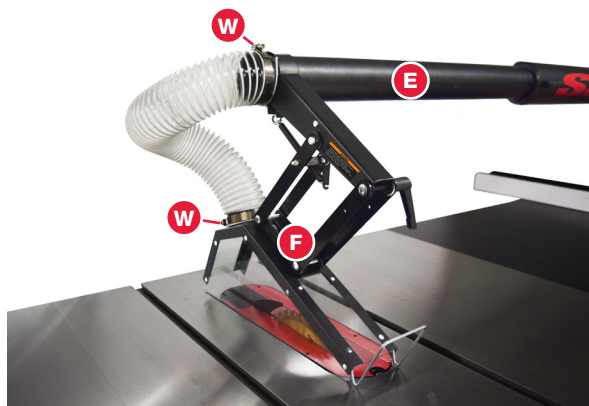

Connecting to a Dust Collection System



CONNECT YOUR FLOATING DUST COLLECTION GUARD TO A DUST COLLECTION SYSTEM BEFORE STARTING YOUR TABLE SAW.

1

Using a 4" hose (not included) and a hose clamp (not included), connect the base of the outer dust tube (D) to a dust collection system.

Make sure that both ends of the dust hose are securely connected and tightly sealed.

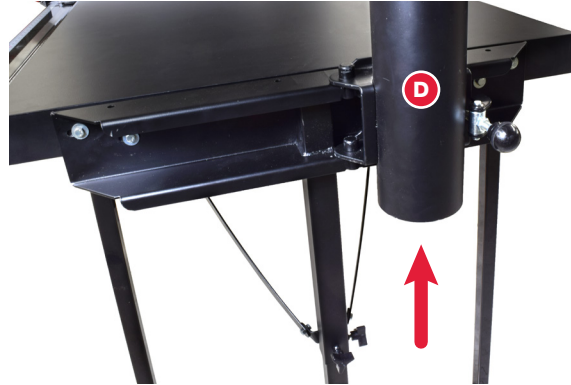

ALWAYS TURN THE DUST COLLECTION SYSTEM ON BEFORE STARTING YOUR TABLE SAW, AND TURN THE DUST COLLECTION SYSTEM OFF AFTER STOPPING YOUR TABLE SAW.

ADJUSTING YOUR FLOATING DUST COLLECTION GUARD

PAGES:
20-22

Adjusting the Dust Tube Parallelism

- 1 If the dust tubes are not parallel with the front and back of the table, the parallelism will need to be adjusted. Ensure the floating blade guard is locked in its retracted position. Next, release the dust tube lock knob and pivot the dust tubes towards the rear of the table.



- 2 Loosen the 5/16"-18 nut using a 1/2" wrench and thread the 5/16"-18 x 1-1/2" hex head bolt in or out relative to the dust collection guard mounting bracket. Once the bolt is in the correct position, use a 1/2" wrench to re-tighten the nut in order to secure the bolt.



Adjusting the Dust Tube Length

- 1 Loosen the inner dust tube lock knob by turning the handle counter-clockwise and slide the inner dust tube in or out of the outer dust tube until the desired position of the floating blade guard is reached.



- 2 Tighten the inner dust tube lock knob by turning the handle clockwise. Do not over-tighten the inner dust tube lock knob.



Adjusting the Floating Blade Guard

- 1 The floating guard lock handle can be used to secure the floating blade guard and prevent vertical movement.

Loosen the lock handle by rotating it in a counter-clockwise direction.

Note: Pull out the lock handle to adjust the positioning.



- 2 Move the floating blade guard up or down to the desired position and then tighten the lock handle by rotating it in a clockwise direction.



i

There are some operations in which the use of the floating dust collection guard system is not practical, and in those cases, the floating blade guard can be lifted up towards the dust tubes and the floating guard lock handle can be tightened to secure it in place.

When pivoting the dust tubes relative to the dust collection guard mounting bracket and when adjusting the lateral position of the floating blade guard, the floating blade guard should always be locked in its upper, or retracted, position.

Adjusting the Floating Blade Guard Spring

- 1 The spring tension knob can be used to adjust the tension of the floating guard spring, which controls the extent to which the floating blade guard is biased towards its upper, retracted position. Rotate the knob clockwise to increase the tension or counter-clockwise to decrease the tension.



MAINTENANCE

- Keep the floating blade guard clean and free of dust to allow unobstructed viewing of the blade and workpiece.
- If any portion of the floating dust collection guard ceases to function properly, replace or repair it before continuing to use the saw.
- When not in use, the floating blade guard can be stored in its upper position, or the dust tube lock knob can be unlocked and the dust tubes and floating dust collection guard can be pivoted away from the saw.
- For more information on dust control and installing a dust collection system, see Woodshop Dust Control, by Sandor Nagyszilanczy, Taunton Press, 2002.

Warranty

SawStop warrants to the original retail purchaser of a new Floating Dust Collection Guard from an authorized SawStop distributor that the floating dust collection guard system will be free from defects in material and workmanship for ONE YEAR from the date of purchase. SawStop warrants to the original retail purchaser of a refurbished, demonstration or floor model Floating Dust Collection Guard from an authorized SawStop distributor that the floating dust collection guard system will be free from defects in material and workmanship for SIX MONTHS from the date of purchase.

This warranty does not apply to defects arising from misuse, abuse, negligence, accidents, normal wear-and-tear, unauthorized repair or alteration, or lack of maintenance. This warranty is void if the floating dust collection guard system or any portion of the floating dust collection guard system is modified without the prior written permission of SawStop, LLC, or if the floating dust collection guard system is located or has been used outside of the country where the authorized SawStop distributor from whom the floating dust collection guard system was purchased resides.

Please contact SawStop to take advantage of this warranty. If SawStop determines the floating dust collection guard system is defective in material or workmanship, and not due to misuse, abuse, negligence, accidents, normal wear-and-tear, unauthorized repair or alteration, or lack of maintenance, then SawStop will, at its expense and upon proof of purchase, send replacement parts to the original retail purchaser necessary to cure the defect. Alternatively, SawStop will repair the floating dust collection guard system provided it is returned to SawStop, shipping prepaid, with proof of purchase and within the warranty period.

SawStop disclaims any and all other express or implied warranties, including merchantability and fitness for a particular purpose. SawStop shall not be liable for death, injuries to persons or property, or incidental, consequential, contingent or special damages arising from the use of the floating dust collection guard system.

This warranty gives you specific legal rights. You may have other rights which vary from state to state.

A table saw is a dangerous tool and there are hazards inherent with using your saw. Some of these hazards are discussed below. Use common sense when operating the saw and floating dust collection guard system and use them only as instructed.

You are responsible for your own safety!

Warnings

1. Read and understand the instruction manual and all safety warnings before operating the saw and floating dust collection guard. Failure to follow instructions or heed warnings may result in electric shock, fire, serious personal injury or property damage. Save these instructions and refer to them whenever necessary.
2. **WARNING:** This product contains one or more chemicals known to the State of California to cause cancer and birth defects or other reproductive harm. In addition, some types of dust created by sawing, power sanding, grinding, drilling, and other construction activities also contain chemicals known to cause cancer, birth defects or other reproductive harm. Some examples of these chemicals are lead from lead-based paints, crystalline silica from bricks, cement, and other masonry products, and arsenic and chromium from chemically treated lumber. In addition, wood dust has been listed as a known human carcinogen by the U.S. government. The risk from exposure to these chemicals and to dust varies depending on how often you do this type of work. To reduce your exposure, work in a well ventilated area and work with approved safety equipment including dust masks or respirators designed to filter out such dust and chemicals.
3. Keep guards in place and in working order. Use the floating dust collection guard and spreader for every operation for which it can be used, including all-through sawing. Use a push stick when required.
4. Wear proper apparel when using the saw and floating dust collection guard. Do not wear loose clothing, gloves, neckties, rings, bracelets, or other jewelry which may get caught in moving parts. Non-slip footwear is recommended. Wear a protective hair covering to contain long hair.
5. Always wear safety glasses when using the saw. Also use a face or dust mask if the cutting operation is dusty. Everyday eyeglasses are not safety glasses.
6. Keep hands out of the line of the saw blade. Never reach around or over the saw blade. Keep proper footing and balance at all times.

7. Maintain the floating dust collection guard as specified in this manual. Use only identical replacement parts when servicing the floating dust collection guard.
8. Turn the power disconnect switch to OFF before servicing the saw and/or floating dust collection guard. Always ensure the power is OFF before changing components or accessories such as blades, brake cartridges, and the like.
9. Check to make sure the saw and floating dust collection guard are in proper working order before using them. For example, check the alignment of moving parts, look to see whether moving parts are binding or rubbing, check to see whether parts are broken, make sure accessories are properly mounted in the saw, and check any other conditions that may affect the operation of the saw or floating dust collection guard. A guard or other part that is damaged should be properly repaired or replaced.

Warning Labels

The following warning label is located on the floating guard support arm within the floating blade guard. Be sure to read all warnings and the warning label before using the saw. A copy of the English text of the warning label is reproduced below:

WARNING

1. Use the blade guard and spreader for every operation for which it can be used.
2. Use the riving knife for non-through sawing.
3. Keep hands away from the saw blade. Use a push-stick when required.

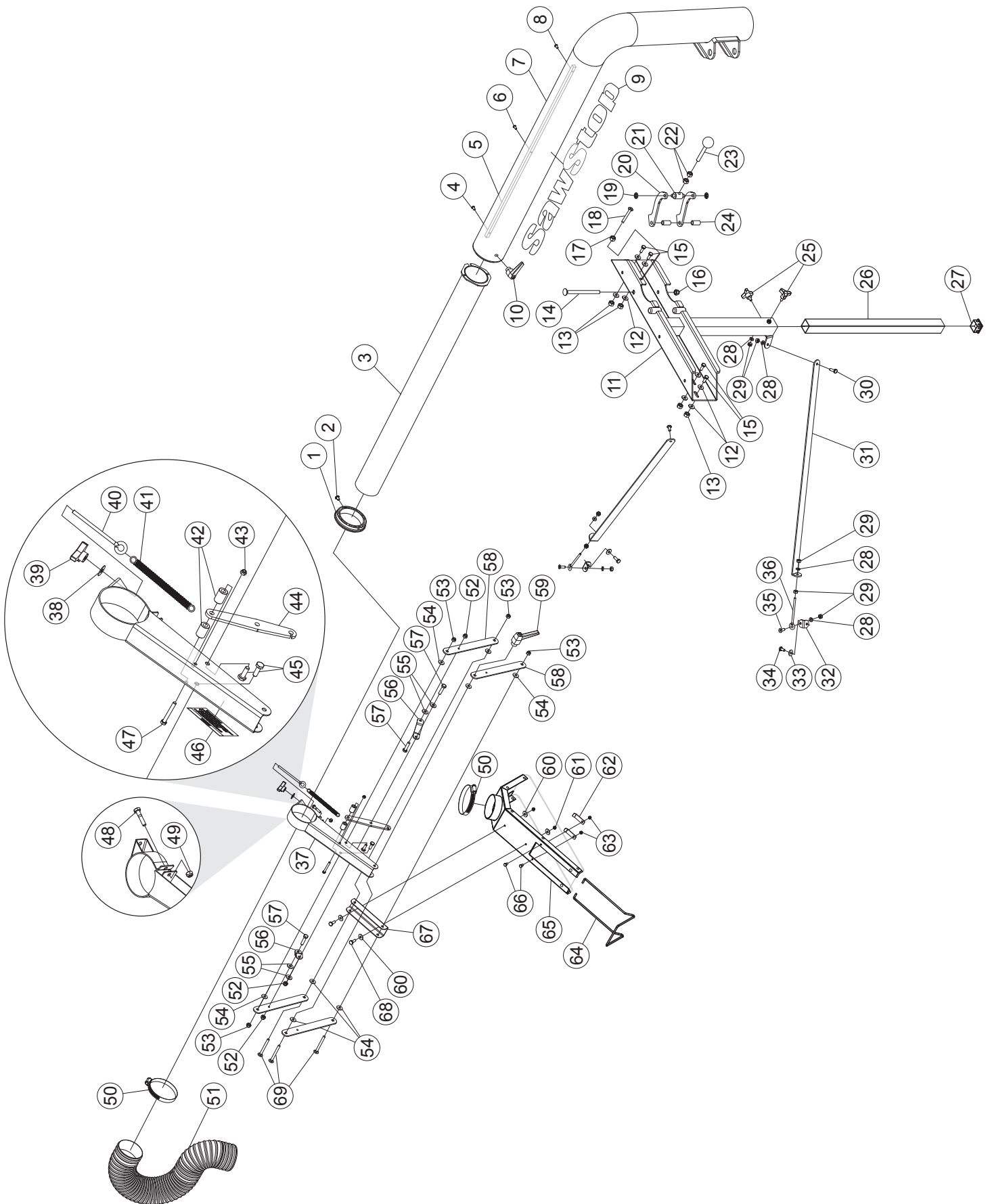

No.	Description	Part No.	Qty.
1	Outer Dust Tube Sleeve	TSG-FDC-001	1
2	1/4"-20 x 3/8" Pan Head Phillips Screw	TSG-FDC-002	1
3	Inner Dust Tube	TSG-FDC-003	1
4	M5 x 0.8 x 12 Button Head Socket Screw	TSG-FDC-004	1
5	Inner Dust Tube Guide Bar	TSG-FDC-005	1
6	M5 x 0.8 x 10 Button Head Socket Screw	TSG-FDC-006	1
7	Outer Dust Tube	TSG-FDC-007	1
8	M5 x 0.8 x 25 Button Head Socket Screw	TSG-FDC-008	1
9	SawStop Label	TSG-FDC-009	1
10	1/4"-20 Inner Dust Tube Lock Knob	TSG-FDC-010	1
11	Dust Collection Guard Mounting Bracket	TSG-FDC-011	1
12	M6 x 19 x 1 Washer	TSG-FDC-012	8
13	M6 x 1.0 Nut	TSG-FDC-013	4
14	3/8"-16 x 4" Carriage Head Bolt	TSG-FDC-014	1
15	M6 x 1.0 x 40 Hex Head Bolt	TSG-FDC-015	4
16	3/8"-16 Lock Nut	TSG-FDC-016	1
17	5/16"-18 Nut	TSG-FDC-017	1
18	5/16"-18 x 1-1/2" Hex Head Bolt	TSG-FDC-018	1
19	5/16" Push Nut	TSG-FDC-019	2
20	Dust Tube Pivot Plate	TSG-FDC-020	2
21	3/8"-16 Dust Tube Barrel Nut	TSG-FDC-021	1
22	3/8"-16 Nut	TSG-FDC-022	2
23	3/8"-16 Dust Tube Lock Knob	TSG-FDC-023	1
24	Dust Tube Pivot Spacer	TSG-FDC-024	2
25	1/4"-20 Extension Leg Lock Knob	TSG-FDC-025	2
26	Extension Leg	TSG-FDC-026	1
27	Leg End Cap	TSG-FDC-027	1
28	1/4" Lock Washer	TSG-FDC-028	6
29	1/4"-20 Nut	TSG-FDC-029	8
30	1/4"-20 x 1/2" Hex Head Bolt	TSG-FDC-030	4
31	Leg Support Bracket	TSG-FDC-031	2
32	Leg Support Mounting Bracket	TSG-FDC-032	2
33	M5 x 12 x 1 Washer	TSG-FDC-033	2
34	M5 x 2.1 x 32 Button Head Phillips Screw	TSG-FDC-034	2
35	1/4"-20 x 3/4" Flat Head Socket Screw	TSG-FDC-035	2
36	1/4"-20 x 4" Eye Bolt	TSG-FDC-036	2
37	Floating Guard Support Arm	TSG-FDC-037	1

Parts List

38	1/4" x 3/4" x 0.08" Washer	TSG-FDC-038	1
39	Spring Tension Knob	TSG-FDC-039	1
40	1/4"-20 x 4" Eye Bolt	TSG-FDC-040	1
41	Floating Guard Spring	TSG-FDC-041	1
42	Tension Plate Spacer	TSG-FDC-042	2
43	M5 x 0.8 Lock Nut	TSG-FDC-043	1
44	Floating Guard Tension Plate	TSG-FDC-044	1
45	1/4"-20 x 1/2" Hex Head Bolt	TSG-FDC-045	2
46	Blade Guard Warning Label	TSG-FDC-046	1
47	M5 x 0.8 x 45 Hex Head Bolt	TSG-FDC-047	1
48	M6 x 1.0 x 40 Button Head Socket Screw	TSG-FDC-048	1
49	M6 x 1.0 Nylok Nut	TSG-FDC-049	1
50	Hose Clamp	TSG-FDC-050	2
51	Dust Collection Hose	TSG-FDC-051	1
52	M5 x 0.8 Lock Nut	TSG-FDC-052	3
53	1/4"-20 Lock Nut	TSG-FDC-053	6
54	M10 x 20 x 1.5 Plastic Washer	TSG-FDC-054	6
55	M5 x 16 x 0.7 Washer	TSG-FDC-055	4
56	Tension Plate Linkage	TSG-FDC-056	2
57	M5 x 0.8 x 16 Hex Head Bolt	TSG-FDC-057	3
58	Floating Guard Link Plate	TSG-FDC-058	4
59	1/4"-20 Floating Guard Lock Handle	TSG-FDC-059	1
60	1/4" x 3/4" x 0.08" Washer	TSG-FDC-060	4
61	1/4"-20 Lock Nut	TSG-FDC-061	2
62	Floating Guard Handle Mounting Plate	TSG-FDC-062	2
63	M4 x 0.7 Lock Nut	TSG-FDC-063	2
64	Floating Guard Handle	TSG-FDC-064	1
65	Floating Blade Guard	TSG-FDC-065	1
66	M4 x 0.7 x 12 Pan Head Phillips Screw	TSG-FDC-066	2
67	Floating Guard Mounting Bracket	TSG-FDC-067	1
68	1/4"-20 x 1/2" Hex Head Bolt	TSG-FDC-068	2
69	1/4"-20 x 2-1/4" Carriage Head Bolt	TSG-FDC-069	3

This page is blank.

SawStop, LLC
11555 SW Myslony St | Tualatin, Oregon 97062 USA
www.sawstop.com

Main Phone: (503) 570-3200
Service: (503) 582-9934
Fax: (503) 570-3303
Email: info@sawstop.com