



INSTALLATION PROCEDURE

The LTS is approved for the five most common installation conditions:

- Condition A:** Sill Plate or Wall Plate Behind Ledger
- Condition B:** Sill Plate or Wall Plate Directly Below Ledger
- Condition C:** Sill Plate or Wall Plate 2" – 5" below Ledger
- Condition D:** Wall Stud in line with Deck Joist
- Condition E:** Wall Stud between Deck Joists



The FastenMaster LTS, is one complete kit to make all five of these code conforming connections. Each LTS bracket attaches an individual deck joist to a structural framing member of the house. With the LTS, you can install the fastener first and then add the bracket. The long fastener allows you to achieve the 3" of threading within the sill plate without having to access the interior of the house. You can achieve the code compliant connection in seconds.

GUARANTEED CORROSION RESISTANCE

LTS is guaranteed not to rust or corrode for the life of the project. The coating on this fastener has been tested in wood treatment chemicals, such as ACQ, and found to provide equivalent protection to code-approved hot-dipped galvanized coatings. LTS is not recommended for use in saltwater applications (within 1,000 ft).

Lateral Tension System SKU Selection Guide

TYPICAL APPLICATIONS	SKU
5 common installation types above	FMLTS-4

Lateral Tension System™

CODE COMPLIANT LATERAL DECK ATTACHMENT

FEATURES

- Meets the 2015 and 2018 IRC
- ACQ Approved Coating
- No pre-drilling required
- No interior access needed to install
- Free bits in every package

PACKAGING QUANTITIES

Each kit contains:

- (4) Lateral Tension Brackets
- (4) Transfer Screws
- (32) Bracket Mounting Screws
- (2) Driver Bits

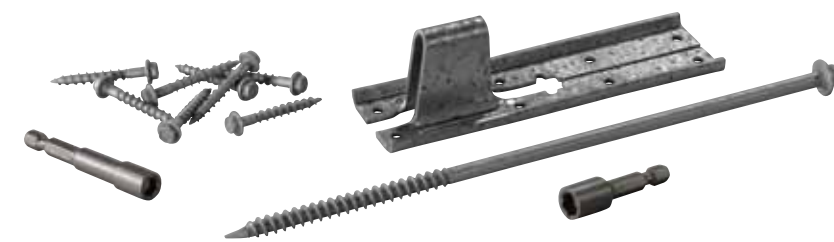

DESCRIPTION

Lateral Tension System™ (LTS) is a complete kit designed to meet the newest code for transferring lateral deck loads. The International Residential Code (IRC) requires that decks be designed to withstand both vertical and lateral loads. This 2015 code allows for tension ties to be attached to the deck joist then fastened directly to an interior sill plate, wall plate or stud – all from the outside.

ADDITIONAL RESOURCES

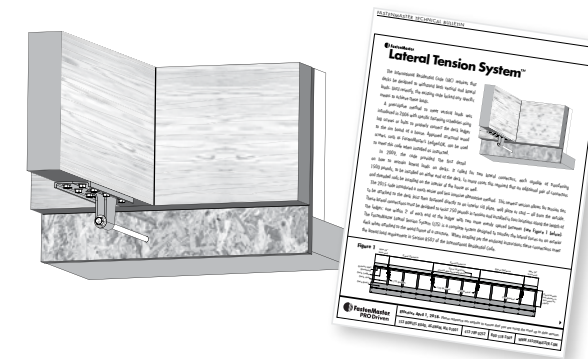

FastenMaster Technical Bulletins

Our Lateral Tension System technical bulletin, which includes detailed installation instructions, fastening requirements and design loads, are available for download from our website.

For additional technical data, refer to pages 55 and 56 of this catalog



ask the
FastenMaster.

Ask the FastenMaster Installation Video

Our Ask the FastenMaster video series includes installation information for many of our products, including our Lateral Tension System video. These can be viewed on our website.

For technical support or to place an order: 800-518-3569 or www.FastenMaster.com

Lateral Tension System™

PRODUCT SPECIFICATION

Tension Transfer Screw

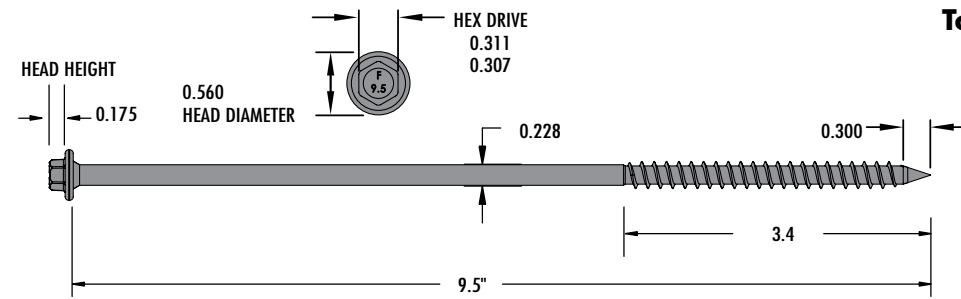

LTS Bracket Top View

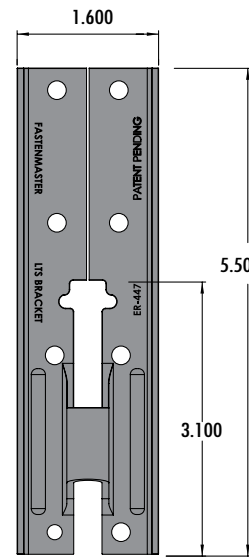

Bracket Mounting Screw

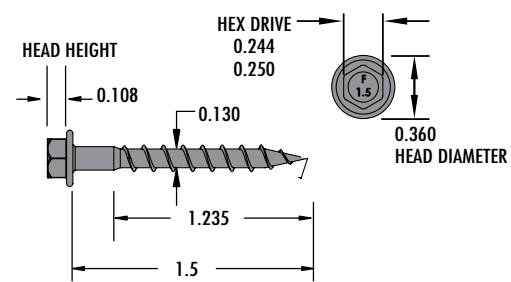

LTS Bracket Profile

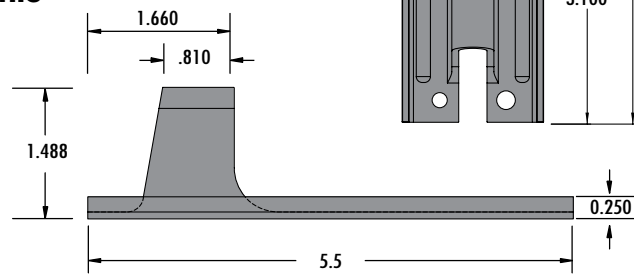

LTS APPLICATIONS

The 2015 code introduced a much easier and less invasive alternative method. This newest version allows for tension ties to be attached to the deck joist then fastened directly to an interior sill plate, wall plate or stud – all from the outside. These lateral connections must be designed to resist 750 pounds in tension and installed in four locations along the length of the ledger: one within 2' of each end of the ledger with two more evenly spaced between (see sample below). The FastenMaster (LTS) is a complete system designed to transfer the lateral forces on an exterior deck when attached to the wood frame of a structure. When installed per the enclosed instructions these connections meet the lateral load requirement in Section R507 of the International Residential Code.

Lateral Tension System Selection Guide			
Part Length	Thread Length	Head Markings	Part Number
9-1/2"	3.4"	F 1.5	FMLTS4

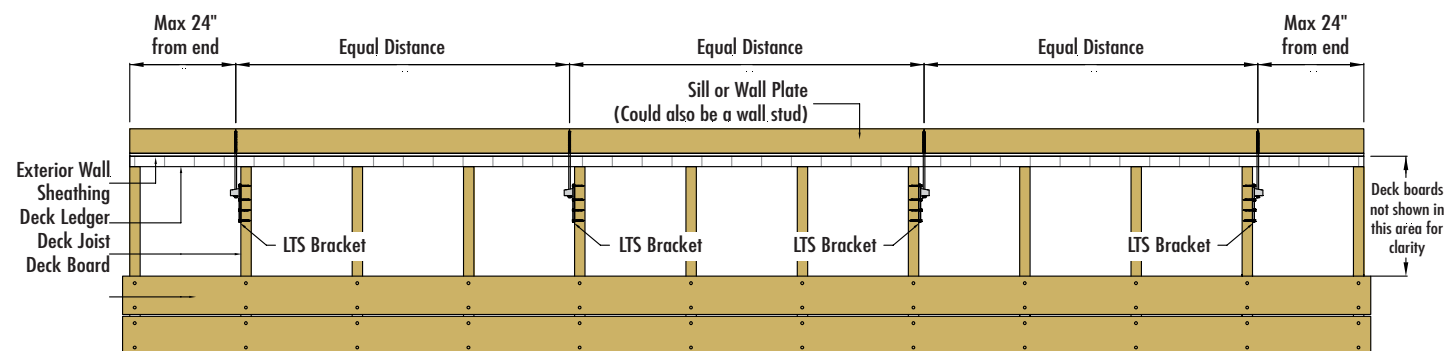

LATERAL TENSION SYSTEM SAMPLE APPLICATIONS

Select the appropriate ledger alignment condition, A through E, based on the orientation of the deck ledger to house framing member that applies to your specific deck. For instructions and additional technical information, consult the **Lateral Tension System Technical Evaluation Report**, available at www.FastenMaster.com.

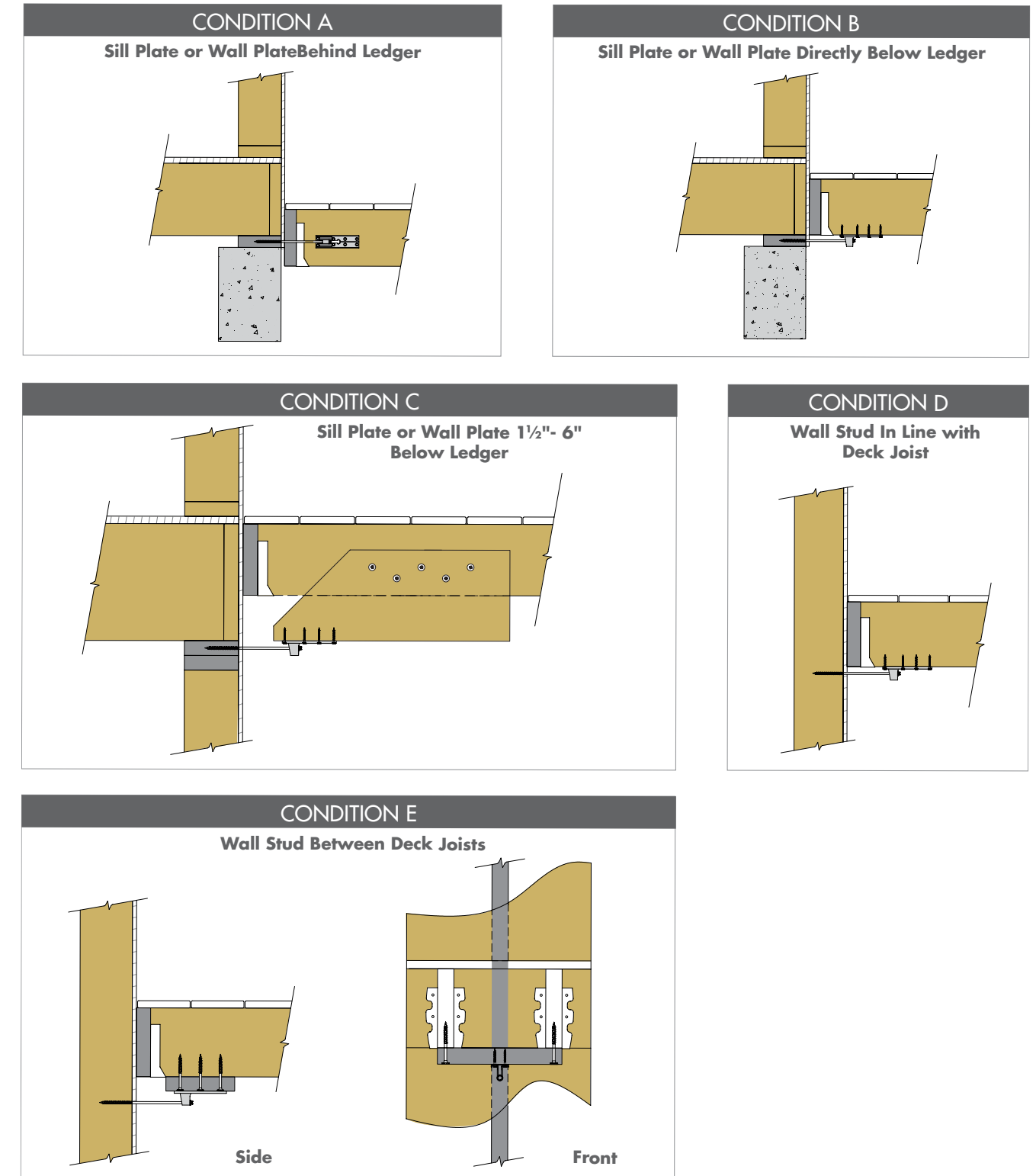

For technical support or to place an order: 800-518-3569 or www.FastenMaster.com