

# Professional Gutter Installation

*Malco*<sup>®</sup>

*Solutions for thin walled K-Style  
and Half Round Gutter.*

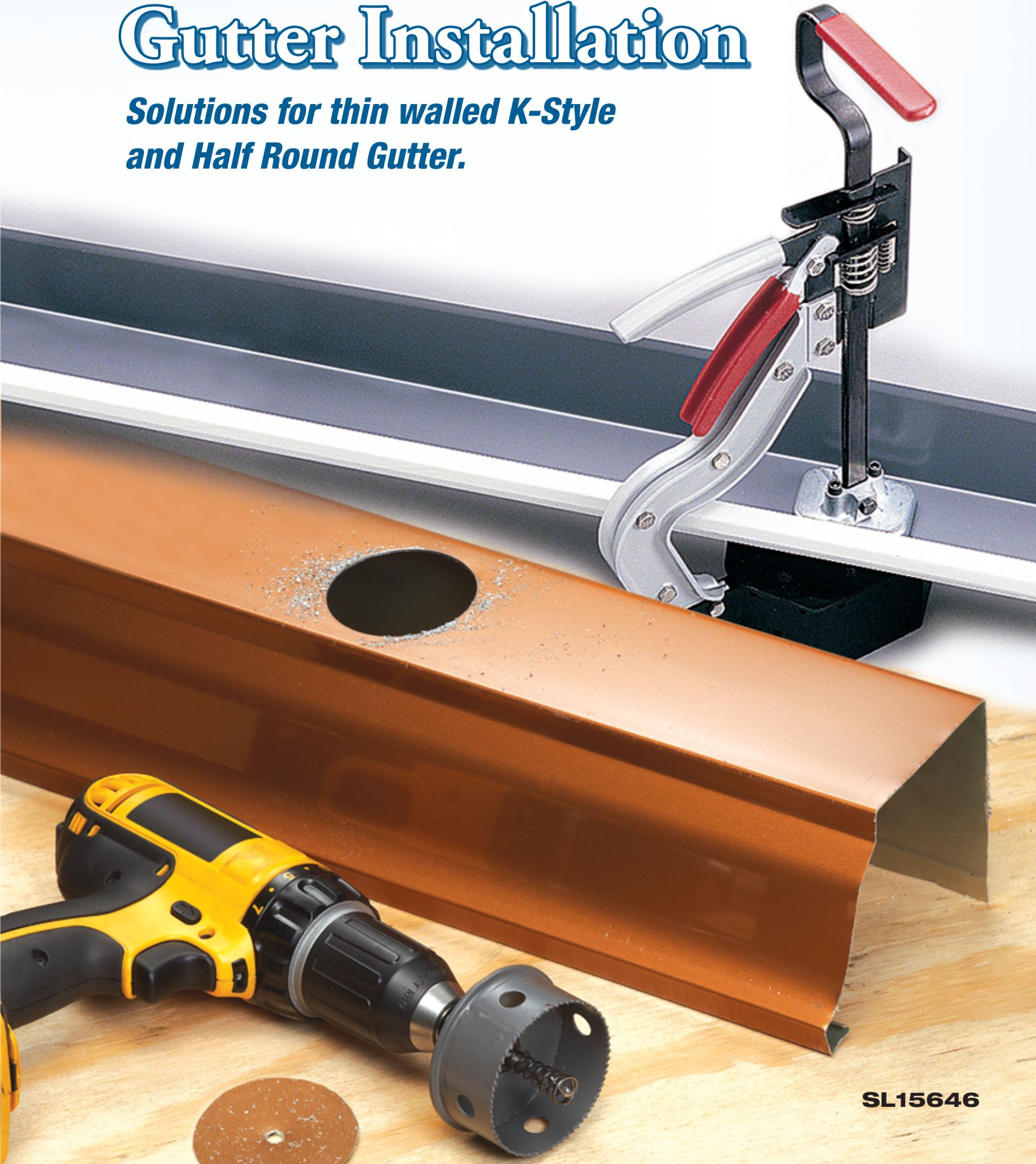

SL15646

# Quick-Action™ Gutter Outlet Saws & Combination Arbor & High Speed Pilot Drill

Fine-tooth, shallow-cup hole saws, for safe, fast, accurate cuts in thin walled half round and K-style gutter. Five saw selections, ensure that downspout fits snug and flush with gutter and drop every time.



**GOS1EV** 2.375 in. (60 mm)    **GOS2EV** 2.75 in. (70 mm)    **GOS3EV** 3 in. (78 mm)    **GOS4EV** 3.5 in. (90 mm)    **GOS5EV** 4 in. (100 mm)



**GOSA1EV**  
*Combination Arbor and High Speed Pilot Drill.*  
Designed specifically for use with Malco Gutter Outlet Saws. Tapered compression spring collar on pilot ejects metal slug.



**10 High Speed Steel Teeth every 1 in. (25.4 mm)**



**Clean cuts with compression spring ejection!**

For use with a 1/2-in. (13 mm) cordless or corded electric drill and a Malco Combination Arbor and High Speed Pilot Drill. High speed steel teeth set at 10 per-in. (per 25.4 mm) will not grab or twist gutter material, even when cutting half round.



Outlet Saw cutting progression in half round gutter.

Operating the Gutter Outlet Saw at low drill speed (approximately 200 RPM) and slightly angling the saw cup to one side produces optimum cutting speed and precise diameters. The shallow cup, and a short pilot drill projection of only 7/16-in. (11 mm) beyond teeth, ensure clean, controlled engagement and safe cutting in thin walled, half-round and K-style gutter. A tapered compression spring collar on the arbor pilot drill bit ejects the cut metal slug.

**Service life of saw averages a minimum of 50 hole cuts in common gutter materials and capacities.**

## Specifications



### Quick-Action™ Gutter Outlet Saws

| Catalog Number | Hole Diameter in. (mm) | Cutting Depth in. (mm) |
|----------------|------------------------|------------------------|
| <b>GOS1EV</b>  | 2.375 in. (60)         | 1 (25.4)               |
| <b>GOS2EV</b>  | 2.75 (70)              | 1 (25.4)               |
| <b>GOS3EV</b>  | 3 (78)                 | 1 (25.4)               |
| <b>GOS4EV</b>  | 3.5 (90)               | 1 (25.4)               |
| <b>GOS5EV</b>  | 4 (100)                | 1 (25.4)               |

### Combination Arbor & High Speed Pilot Drill

| Catalog Number | Pilot Drill Bit         | Arbor Shank in. (mm) | Drill Requirements in. (mm) |
|----------------|-------------------------|----------------------|-----------------------------|
| <b>GOSA1EV</b> | 5.9 mm High Speed Steel | 13/32 (10)           | .5 in. (13) Chuck           |

## Capacities

|  |  |
|--|--|
|  | Aluminum - .017 - .032 in. (0.43 -0.81 mm)   |
|  | Zinc Coated Aluminum - .018 in. (0.46 mm)<br>Galvanized Aluminum - .023 in. (0.58 mm)<br>Painted Steel - .021 in. (0.53 mm)<br>Copper - 22 oz. |

# Gutter Outlet Punch

## System for K-Style Aluminum Gutter!

For cutting downspout drop holes in K-style aluminum gutter, nothing else matches the speed and accuracy of the Malco Gutter Outlet Punch System. A versatile, lightweight Malco Tool Frame accepts your choice of separate Malco Rectangular and X-style Punch and Die combinations, including a **New 3-in. X 4-in. (76 x 102 mm) X-Style Punch and Die!**

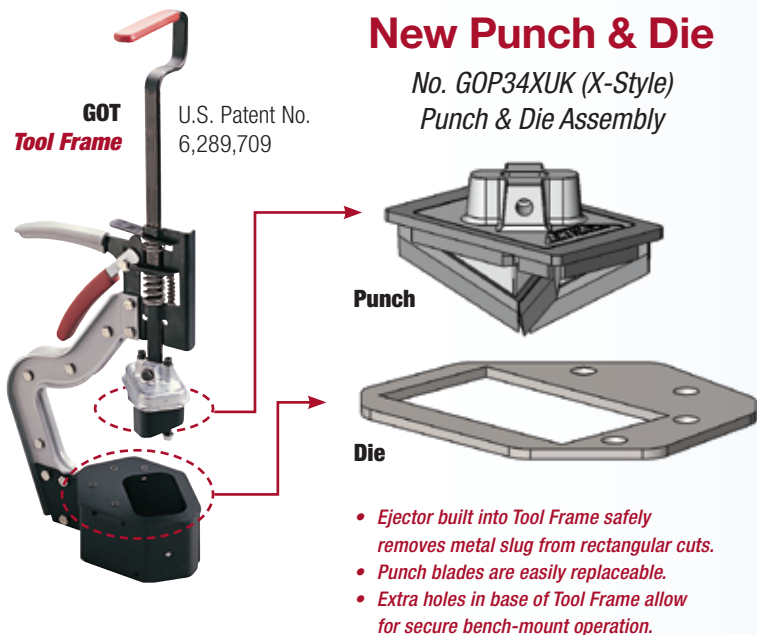

Use the lightweight aluminum and steel tool frame and the punch and die combination of choice to cut a clean drop hole anywhere along the length of standard 5 or 6-in. K-style aluminum gutter up to .032-in (0.81 mm) thickness. The tool frame features ample throat clearance and open sides to allow the punch access over the front edge of the gutter and quickly line up cuts in either "A" or "B" direction. The tool frame's easy ratcheting mechanism, and the angled blades of the punch, combine to provide a smooth cutting action. A built-in ejector on the frame safely removes the metal slug from rectangular cuts. High carbon steel blades ensure long punch life. Heat treated components and weather resistant finishes on both the tool frame component and all punch and die assemblies ensure long service life. Fastener holes are provided in the tool base for bench-mount operation.

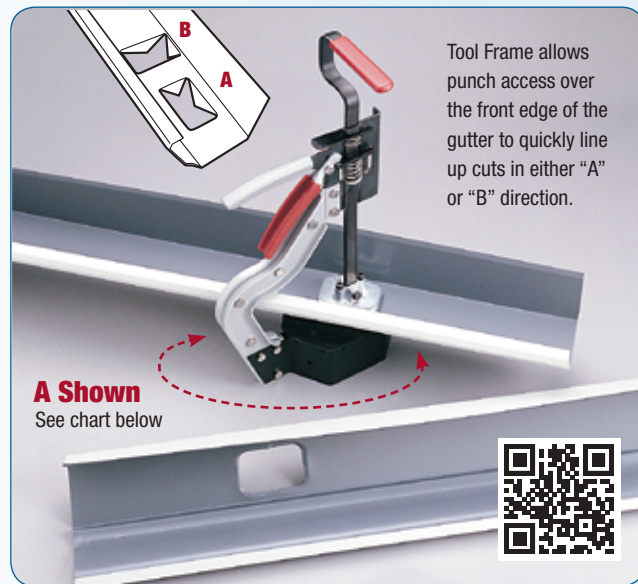

### Specifications

#### Gutter Outlet Tool Frame

| Catalog Number | Description        | Nominal Tool Weight w/ Punch & Die lbs. (kg) | Dimensions in. (cm) |
|----------------|--------------------|--|---------------------|
| <b>GOT</b>     | Tool Frame         | 8.0 (3.63)                                   | 19 x 10 (48 x 25)   |
| <b>GOTRC</b>   | Replacement Chocks | —  | —                   |

#### Punch & Die Assemblies and Replacement Blades

| Catalog Number  | Description  | Dimensions in. (mm) |
|-----------------|--|---------------------|
| <b>GOP23UK</b>  | Punch and Die Assembly - Standard Rectangular Hole | 2 x 3 (51 x 76)     |
| <b>GOPRB</b>    | GOP23UK Replacement Blade                          |                     |
| <b>GOP23LUK</b> | Punch and Die Assembly - Oversize Rectangular Hole | 2.2 x 3.2 (56 x 81) |
| <b>GOP23LRB</b> | GOP23LUK Replacement Blade                         |                     |
| <b>GOP34UK</b>  | Punch and Die Assembly - Standard Rectangular Hole | 3 x 4 (76 x 102)    |
| <b>GOP23XUK</b> | Punch and Die Assembly - X-Style                   | 2 x 3 (51 x 76)     |
| <b>GOP23XRB</b> | GOP23XUK Replacement Blade                         |                     |
| <b>GOP34XUK</b> | <b>NEW</b> Punch and Die Assembly - X-Style        | 3 x 4 (76 x 102)    |
| <b>GOP34XRB</b> | GOP34XUK Replacement Blade                         |                     |



#### Reference Chart

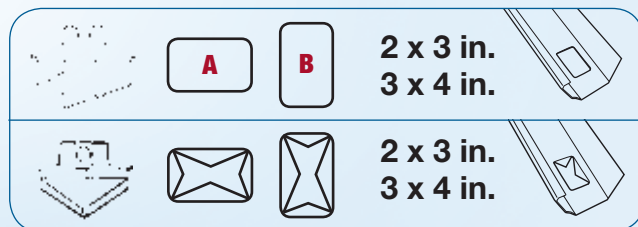

# Gutter & Downspout Tools

## Gutter Nail Driver

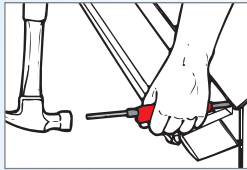

Working from  
*Above*

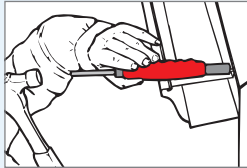

Working from  
*Below*



GND

## Snap Lock Punch

*Not recommended  
for heavy sheet metal.*



SL2R

Works anywhere to attach gutter to fascia with ease.

Use the Malco Gutter Nail Driver with hidden hangers and 8D galvanized nails to hang aluminum or steel gutters. A non-slip ergonomic grip provides multiple positions for grasping tool and working from above or below roof overhang. Durable 2-piece steel construction plus weather resistant zinc and nickel plating assure long service life of this professional quality tool.

Ideal for end caps on gutter.

Slide adjustment for throat depth allows settings from 1/4 in. to 5/8 in. (6 to 16 mm) depth. Also used to crimp end caps on gutter. Nickel plate and black oxide finish. Formed metal cutting jaws. Ergonomic Redline Handles with unique one-hand operation latch offer maximum compound leverage performance and natural fit and feel.

## 5 Blade Crimper



C4R

Produces a double crimp that downsizes without deforming downspout; walls stay square for a tight fitting, leakproof connection.

Tool also features rust resistant plating. Ergonomic Redline Handles with unique one-hand operation latch offer maximum compound leverage performance and natural fit and feel.

## Single Crimper



SC2

Light Duty tool without grips.

Makes a single crimp for downsizing aluminum downspouts.

## Specifications

| Catalog Number    | Description        | Throat Depth<br>in. (mm) | Variable Leverage Ratio<br>(High / Low) throughout stroke | Jaws                     | Length<br>in. (mm)        | Net Wt.<br>oz. (g)  |
|-------------------|--------------------|--------------------------|---|--------------------------|---------------------------|---------------------|
| <b>GND</b>        | Gutter Nail Driver | —                        | —   | —                        | 7-5/8 (194)               | 7 (199)             |
| <b>SL2R</b>       | Snap Lock Punch    | 1/4 to 5/8 (6 to 16)     | —   | —                        | 8 (203)                   | 16 (454)            |
| <b>C4R</b>        | 5 Blade Crimper    | 1-1/4 (31.8)             | 7.1 to 1.0 - 9.8 to 1.0                                   | Carbon Steel             | 9 (229)                   | 16 (454)            |
| <b>SC2</b>        | Single Crimper     | 1-1/8 (28.6)             | —   | —                        | 8 (203)                   | 8 (227)             |
| <b>CAPACITIES</b> | Material           | Aluminum                 | Copper  | Stainless Steel 26 Gauge | Galvanized Steel 24 Gauge | Mild Steel 24 Gauge |
| <b>C4R</b>        | in. (mm)           | 0.035 (0.89)             | 0.023 (0.58)  | 0.018 (0.46)             | 0.028 (0.71)              | 0.024 (0.61)        |

Malco Products, Inc. | Annandale, Minnesota, U.S.A. | [www.malcotools.com](http://www.malcotools.com) | ©2013

U.S. 320-274-7387 - 800-328-3530 | Canada: 320-274-2376 • 800-219-1085 | International: 01-320-274-2376