

Model: 53498



**Actual product may vary slightly*

Please carefully read and save these instructions before attempting to assemble, maintain, install, or operate this product. Observe all safety information to protect yourself and others. Failure to observe the instructions may result in property damage and/or personal injury. Please keep instructions for future reference.

For warranty purchases, please keep your dated proof of purchase. File or attach to the manual for safe keeping.

IMPORTANT SAFETY INSTRUCTIONS

PLEASE SAVE THIS OWNERS MANUAL AND READ BEFORE EACH USE.

This manual will explain how to use the product safely and effectively.

Please read and follow these instructions and precautions carefully.

CALIFORNIA PROPOSITION 65

WARNING:

You can create dust when you cut, sand, drill or grind materials such as wood, paint, metal, concrete, cement, or other masonry. This dust often contains chemicals known to cause cancer, birth defects, or other reproductive harm.

Wear protective gear.

WARNING:

This product or its power cord may contain chemicals, including lead, known to the State of California to cause cancer and birth defects or other reproductive harm. Wash hands after handling.

IMPORTANT!

When using equipment, a few safety precautions must be observed to avoid injuries and damage. Please read the complete operating manual with due care. Keep this manual in a safe place, so that the information is available at all times. If you give the equipment to any other person, give them these operating instructions as well. We accept no liability for damage or accidents which arise due to non-observance of these instructions and the safety information herein.

WARNING!

TO AVOID SERIOUS INJURY

- Continuous adult supervision required.
- Never use near motor required.
- Never use near street, swimming pools, hills, steps, or sloped driveways.
- Never ride this tricycle on the public roads.
- Always wear shoes when using the tricycle.
- Riders should always wear a properly fitted helmet that complies with U.S. consumer product safety commission (CPSC) standard 16 CFR. 1203.
- Inspect before each use.
- Do not use broken, bent, cracked or damaged parts.
- Age 3 and up only.
- Max loading capacity--tricycle: 130 lbs; wagon: 100 lbs.
- Allow only one rider.

ASSEMBLY INSTRUCTIONS

PRE-ASSEMBLY

You will need a slot screwdriver, hex screwdriver long nose pliers and an adjustable wrench for assembly. Make sure to assemble the product by following this instruction completely and properly.

MAINTENANCE

For the sake of safety, periodically inspect all moveable parts of the unit, and perform proper maintenance if necessary.

TRICYCLE HARDWARE LIST

No.:	Description	Qty's
1	Bolt Ø8mm	4
2	Washer Ø8mm	4
3	Nut Ø8mm	6
4	Washer	2
5	Wheel Cover	2
6	Socket Head Cap Screw & Nut	1

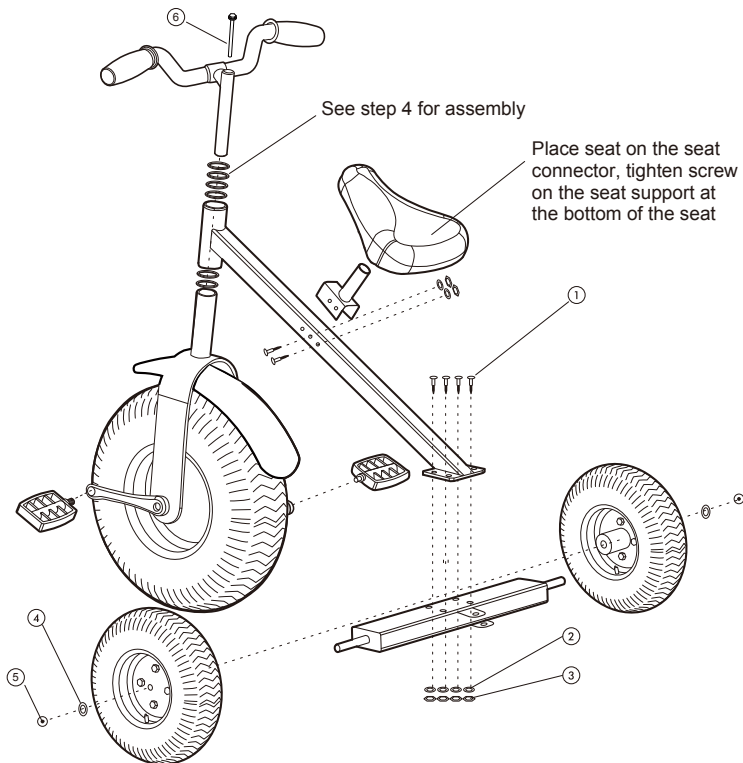

TRICYCLE ASSEMBLY INSTRUCTIONS

SETUP 1.

Place the back wheel (E) onto the back axle (A), put a flat washer (4) on the axle, use pin (5) and wheel cover (7) to lock the back wheel in place. Repeat step 1 to assemble other back wheel.

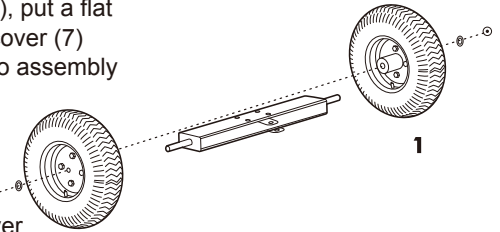

SETUP 2.

Attach the back axle (A) to the fork and frame (H). Secure the back axle (A) with bolts (E), washers (2) and nuts (3) by a phillips screwdriver and wrench.

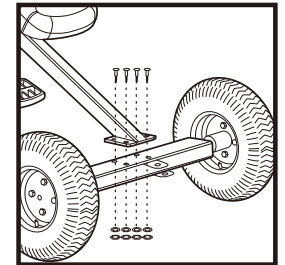

SETUP 3.

Use wrench to secure the pedal (D) onto the threaded crank adjacent to the front wheel (G). Repeat step 3 to install the second pedal. Fasten the short bolt (8) at the right side of front wheel axle.

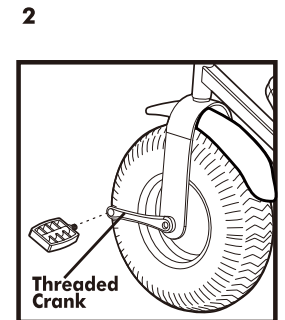

SETUP 4.

Follow diagram 4 to put nuts, washer, rings, fork and frame together.

SETUP 5.

To assemble the handlebars (F), align the "nut boss" with the slot into the tube, tighten the top screw by hand, Insert the handlebars (F) into the hole of the front axle, use hex screwdriver to tighten top screw. Please ensure over minimum insertion marking position when tighten the top screw.

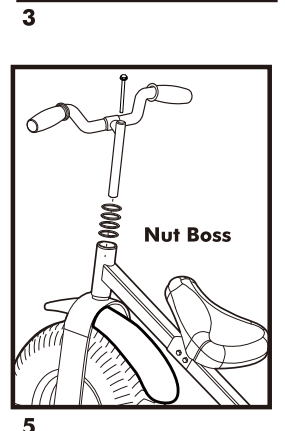
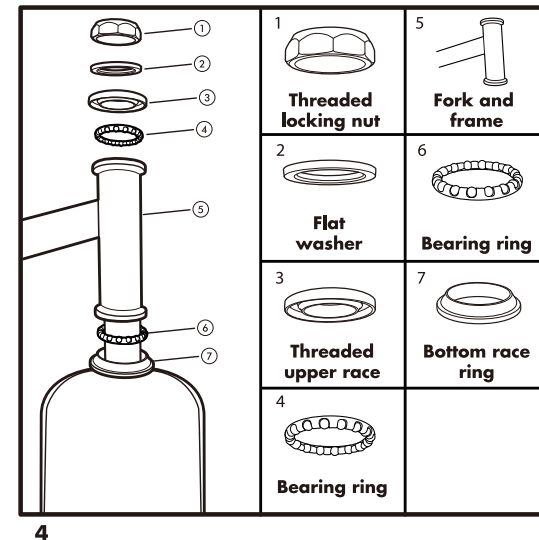

TRICYCLE ASSEMBLY INSTRUCTIONS

SETUP 6.

To adjust the seat position, unscrew screws, place seat connector to match holes to the desired position, tighten screws to lock seat in place.

NOTE: While seat installation/adjustment, reverse seat connector to desired position.

SETUP 7.

Test the Tricycle by checking all bolts and fittings, make sure everything is securely tightened. Roll the tricycle to check for proper wheel operation. Periodically check tire pressures, for front and rear tires, do not exceed 35 (front) and 30 (rear) PSI respectively.

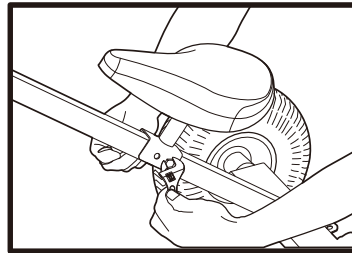

6

TRICYCLE PART LIST:

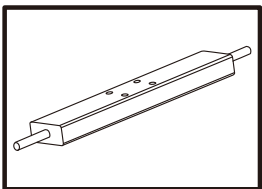

A. Back Axle x1

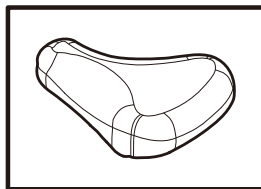

B. Seat x1

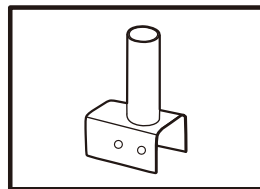

C. Seat Connector x1

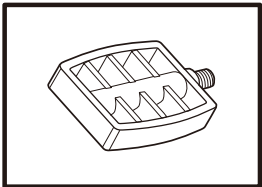

D. Pedals x2

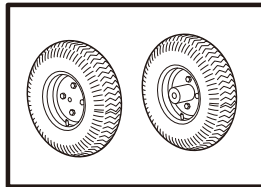

E. Back Wheels x2

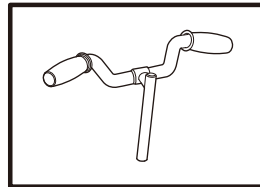

F. Handlebars x1

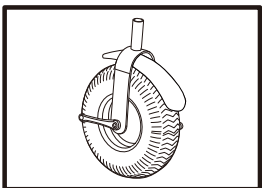

G. Front Wheel x1

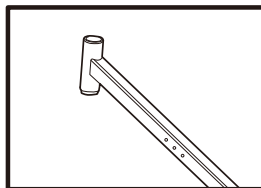

H. Fork and Frame x1

WAGON ASSEMBLY INSTRUCTIONS

WAGON HARDWARE LIST

No.	Description	Qty's
1	Bolt M8 x 45mm	1
2	Washer Ø8mm	1
3	Nut M8	1
4	Washer Ø16mm	1
5	Nut Cover	1

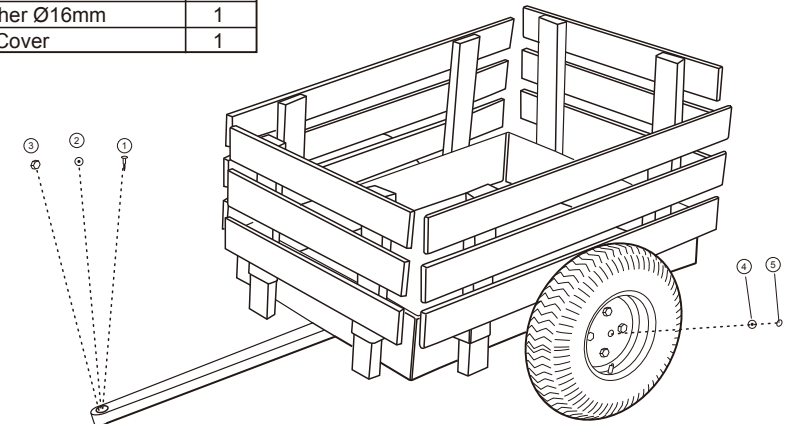

WAGON ASSEMBLY INSTRUCTIONS

SETUP 1.

Put the axle (E) to the deck (A), place the wheel (B) to the axle (E). Use pin (2) and wheel cover (3) to lock the wheel. Repeat step 1 to assemble other wheel.

SETUP 2.

Attached the deck (A) to the tricycle with clevis pin (1) and pin (2).

SETUP 3.

Insert the long fences (C) and short fence (D) to the deck (A).

WAGON PART LIST:

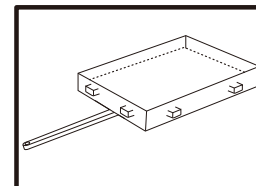

A. Deck x1

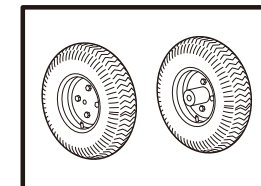

B. Wheels x2

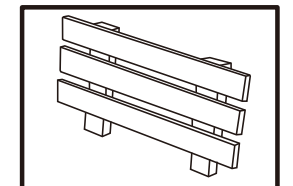

C. Long Fence x2

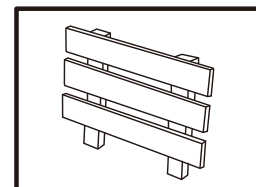

D. Short Fence x2

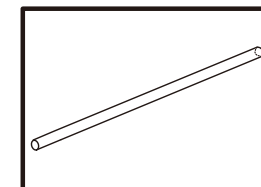

E. Axle x1

PART LIST

Part	Description	Qty
1	Front Wheel	1
2	Front Fork & Fender	1
3	Bearing Head Set	1
4	Front Wheel Axle Shaft	1
4a	M8 Bolt of Axle Shaft	1
5a	Pedal(Left side,normal threads)	1
5b	Crank(Left side,normal threads)	1
6a	Pedal(Right side,reverse threads)	1
6b	Crank(Right side,reverse threads)	1
7a	Crank Nut	2
7b	Crank Pin	2
7c	Washer for Crank Nut	16
8	Frame	1

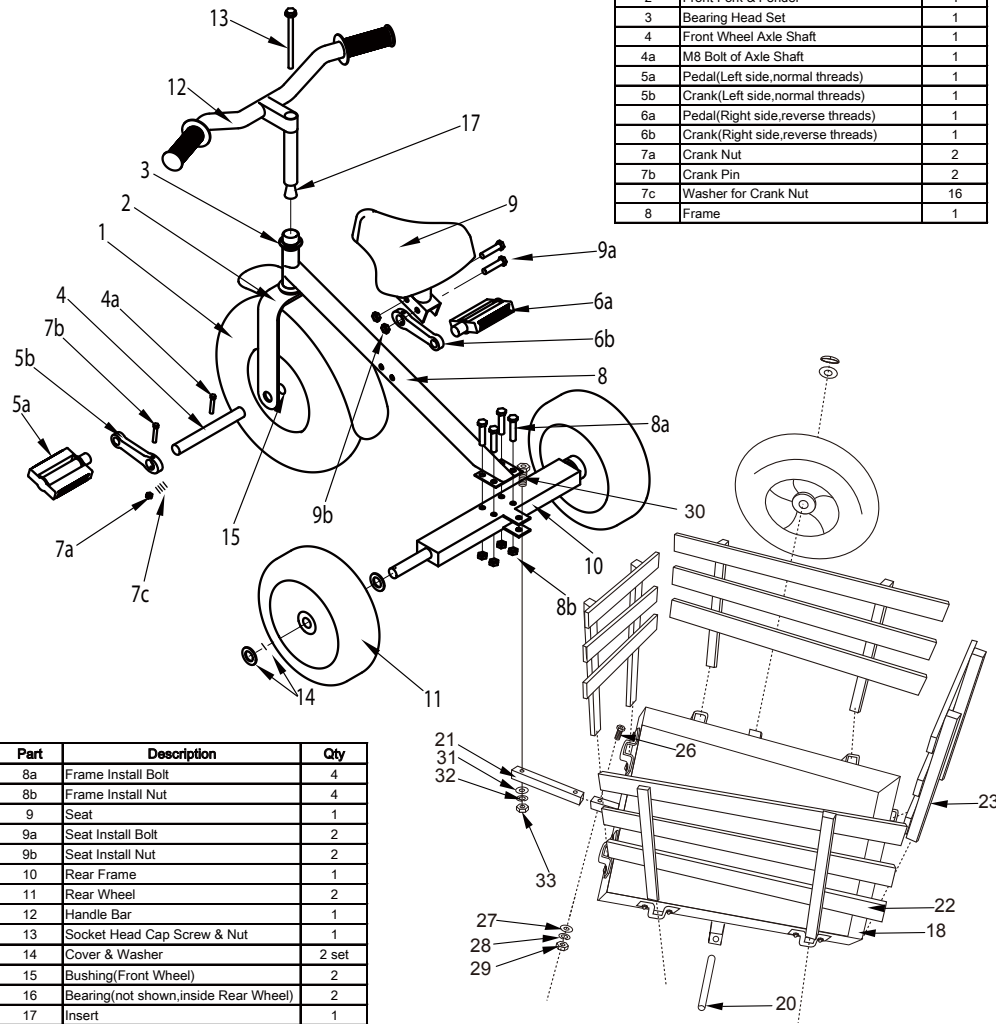

Part	Description	Qty
8a	Frame Install Bolt	4
8b	Frame Install Nut	4
9	Seat	1
9a	Seat Install Bolt	2
9b	Seat Install Nut	2
10	Rear Frame	1
11	Rear Wheel	2
12	Handle Bar	1
13	Socket Head Cap Screw & Nut	1
14	Cover & Washer	2 set
15	Bushing(Front Wheel)	2
16	Bearing(not shown,inside Rear Wheel)	2
17	Insert	1

Part	Description	Qty	Part	Description	Qty
18	Steel Deck	1	26	Bolt M6 x 45mm	1
19	Wagon Wheel	2	27	Washer Φ6mm	1
20	Axle	1	28	Spring Washer Φ6mm	1
21	Extention Rod	1	29	Nut M6	1
22	Long Fence	2	30	Bolt M8 x 45mm	1
23	Short Fence	2	31	Washer Φ8mm	1
24	Washer Φ16mm	2	32	Spring Washer Φ8mm	1
25	Nut Cover M16	2	33	Nut Φ8mm	1

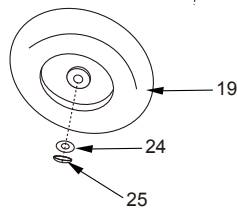

Limited Manufacturer Warranty

North American Tool Industries (NATI) makes every effort to ensure that this product meets high quality and durability standards. NATI warrants to the original retail consumer a 1-year limited warranty from the date the product was purchased at retail and each product is free from defects in materials. Warranty does not apply to defects due directly or indirectly to misuse, abuse, negligence or accidents, repairs or alterations, or a lack of maintenance. This product is intended for personal use. The warranty will be voided if used in commercial, rental, or industrial applications. NATI shall in no event be liable for death, injuries to persons or property, or for incidental, special or consequential damages arising from the use of our products. To receive service under warranty, the original manufacturer part must be returned for examination by an authorized service center. Shipping and handling charges may apply. If a defect is found, NATI will either repair or replace the product at its discretion.

DO NOT RETURN TO STORE

For Customer Service:

Email feedback@natitools.com or

Call 1-800-348-5004